

### MINNESOTA DIVISION

**D. W. SCOTT**—Division Superintendent, Minneapolis

R. C. LIGGETT	Terminal Superintendent	Minneapolis
G. D. ANDERSON	Asst. Supt. Transportation	Minneapolis
M. G. HEYNS	Asst. Supt. Transportation	Sioux City
R. D. SHERVE	Asst. Supt. Administration	Minneapolis
J. A. HOVLAND	Asst. Supt. Roadway Maintenance	Minneapolis
G. A. NYBERG	Asst. Supt. Roadway Maintenance	Willmar
C. L. CARLSON	Asst. Terminal Supt. Transportation	Minneapolis
L. G. FORCIEA	Asst. Terminal Supt. Administration	Minneapolis
W. L. WATLAND	Regional Chief Dispatcher	Minneapolis
P. J. PAYTON	Terminal Manager-Compass	Minneapolis
R. L. HAUBRICK	Terminal Manager	Mpls - St. Paul
J. D. CROWLEY	Terminal Manager	St. Cloud
M. C. BRUCE	Trainmaster	Sioux City
R. E. MACKENROTH	Trainmaster	Willmar
W. J. THOMPSON	Trainmaster-Road Foreman	Staples
D. C. CHRISTENSON	Trainmaster-Agent	Sioux Falls
D. J. JOHNSON	Supvr. of Administration	Minneapolis
D. D. DAHL	Terminal Trainmaster	Minneapolis
J. L. SCHMIDT	Terminal Trainmaster	Minneapolis
B. HUNTER, JR.	Terminal Trainmaster	Minneapolis
R. P. LEIN	Terminal Trainmaster	Minneapolis
J. W. LONG	Terminal Trainmaster	Minneapolis
D. A. MCGOVERN	Terminal Trainmaster	Minneapolis
D. C. SPLAIN	Terminal Trainmaster	Minneapolis
D. J. BANKE	Asst. Terminal Trainmaster	Minneapolis
P. LECHOLAT	Road Foreman	Willmar
G. SERNA	Trainmaster-Road Foreman	Minneapolis
R. W. RICHTER	Road Foreman	Minneapolis
J. R. SPEALMAN	Road Foreman	Sioux City

### WISCONSIN DIVISION

**A. J. THOMPSON**—Division Superintendent, Superior

W. R. GRIMSTAD	Terminal Superintendent	Superior
L. M. TERRY	Asst. Supt. Transportation	Superior
J. D. GABIOU	Asst. Supt. Transportation	Grand Forks
J. H. FRASER	Asst. Supt. Roadway Maintenance	Superior
W. L. WATLAND	Regional Chief Dispatcher	Minneapolis
W. H. DZUCK	Chief Dispatcher	Superior
R. E. BRIDGEWATER	Trainmaster	Superior
A. W. SANTA	Trainmaster	Kelly Lake
K. C. ROWND	Trainmaster-Road Foreman	Grand Forks
S. L. WINGAD	Terminal Trainmaster	Superior
W. J. COBEAN	Trainmaster	Grand Forks
A. E. MORIN	Asst. Trainmaster	Grand Forks
W. R. O'NEILL	Terminal Trainmaster	Superior
M. D. McLAUGHLIN	Asst. Terminal Trainmaster	Superior
W. D. KLEIN	Trainmaster-Agent	Brainerd
E. FRANK	Road Foreman	Superior
W. L. ANDERSEN	Road Foreman	Superior

### DAKOTA DIVISION

**D. E. BAKER**—Division Superintendent, Fargo

G. E. SMITH	Asst. Supt. Transportation	Minot
W. E. TRAUT	Asst. Supt. Transportation	Fargo
K. R. GAGE	Asst. Supt. Administration	Fargo
R. R. EISENZIMMER	Asst. Supt. Roadway Maintenance	Fargo
W. L. WATLAND	Regional Chief Dispatcher	Minneapolis
J. L. REINKE	Chief Dispatcher	Minot
A. L. SIMMERT	Terminal Manager	Fargo
F. E. WEST	Trainmaster-Road Foreman	Dilworth
C. E. KEELER	Trainmaster-Road Foreman	Dilworth
B. M. BATTERSON	Trainmaster-Road Foreman	Dilworth
B. A. BRYAN	Terminal Trainmaster	Minot - Gavin Yard
J. W. ELLSTROM	Terminal Trainmaster	Minot - Gavin Yard
M. S. DANIELS	Asst. Terminal Trainmaster	Minot - Gavin Yard
M. F. DUPHORN	Trainmaster	Minot
R. R. ENGLESON	Trainmaster-Road Foreman	Minot
J. R. RUSK	Trainmaster-Road Foreman	Jamestown

# BURLINGTON NORTHERN RAILROAD CO. TWIN CITIES REGION

Minnesota, Wisconsin, and  
Dakota Divisions

# TIME TABLE 33

To be used in conjunction with  
Special Instructions currently in effect

IN EFFECT AT 12:01 A.M.

Central Standard Time

Sunday, April 25, 1982

INCLUDING NATIONAL RAILROAD  
PASSENGER CORPORATION (NRPC) TRAINS

Vice President  
Transportation  
T. C. WHITACRE

Vice President and  
General Manager  
C. J. BRYAN



MINNESOTA DIVISION

WESTWARD	Rule 6(A) Signs	Length of Siding in Feet	Station Numbers	Line Segment	Mile Post Location	Distance From Lyndale Jct.	2nd Subdivn MAIN LINE		EASTWARD
							STATIONS		
							Office Calls		
	JRY		03004		12.4	0.0	DT	LYNDALE JCT. 11.7	Rule 251-254
	J	10,722	03014		24.3	11.7		WAYZATA 7.5	
			03022		31.6	19.2		MAPLE PLAIN 7.0	
		10,291	03029		38.6	26.2		DELANO 9.4	
			03038		48.1	35.6		WAVERLY 5.0	
		15,614	03043		53.0	40.6		HOWARD LAKE 6.3	
		7,277	03050		59.4	46.9		COKATO 5.8	
		8,547	03056		65.2	52.7		DASSEL 5.1	
			03061		70.3	57.8		DARWIN 6.2	
		8,713	03067		76.4	64.0	FD	LITCHFIELD 7.7	
			03074		84.1	71.7		GROVE CITY 5.1	
		10,452	03080		89.2	76.8		ATWATER 5.8	
			03087		96.6	84.2		KANDIYOHI 5.8	
	BJK RT		03092	22	102.3	90.0	2MT	W WILLMAR 6.8	CTC
			03099		108.9	96.6		PENNOCK 7.4	
		8,866	03107		116.3	104.0		KERKHOVEN 4.5	
			03111		120.8	108.5		MURDOCK 4.8	
			03166		125.3	113.1		DE GRAFF 7.0	
	JKT	18,443	03123		132.3	120.1	BN	BENSON 6.2	
			03129		138.5	128.3		CLONTARF 10.2	
			03139		148.7	136.5		HANCOCK 8.8	
	BJK RT	20,074	03148		157.6	145.3	MR	MORRIS 8.2	
		7,384	03156		165.7	153.5		DONNELLY 10.5	
			03167		176.2	164.0		HERMAN 4.9	
		7,174	03172		181.0	168.9		NORCROSS 11.5	
			03183		192.7	180.4		TINTAH 2.8	
	J		03186		195.6	183.2		ABERDEEN LINE JCT. 4.4	
		13,756	03190		199.8	187.6		CAMPBELL 7.2	
			03198		206.9	194.8		DORAN 7.9	
	BIJ KRT		03204		215.0	202.7	BR	BRECKENRIDGE	

BN Radio Channel No. 3 in service for yard forces Minneapolis area.

MINNESOTA DIVISION

3

WESTWARD	Rule 6(A) Signs	Length of Siding in Feet	Station Numbers	Line Segment	Mile Post Location	Distance From Sioux City	3rd Subdivn MAIN LINE		EASTWARD
							STATIONS		
							Office Calls		
	BKRTY		07109		223.2	0.0	SX	SIoux CITY (18th Street Yard) 8.9	
		2,790	07118		212.7	8.9		HINTON 1.3	
	A		07119		211.4	10.2		WREN TOWER 5.5	
		7,000	07125		205.9	15.7		MERRILL 12.5	
			07138		193.4	28.2		STRUBLE 13.2	
		7,000	07151		180.2	41.4	UX	SIoux CENTER 16.6	
			07168		163.6	58.0		DOON 5.7	
		5,198	07173		158.0	63.7		ALVORD 6.8	
		5,179	07180		151.1	70.5		LESTER 6.5	
	A	5,151	07187		144.7	77.0		HILLS 17.3	
	JKRTY	7,277	07204		127.3	94.3	JC	GARRETSON 11.0	
			07215		116.3	105.3		JASPER 4.6	
		6,170	07220	197	111.7	109.9		IHLEN	
	UY	1,695	07226		105.0	116.7	NE	PIPESTONE 8.8	
			07235		96.2	125.5		HOLLAND 7.8	
		7,000	07243		88.3	133.3		RUTHTON 5.0	
			07248		83.3	138.3		FLORENCE 7.9	
		2,680	07256		75.5	146.2		RUSSELL 12.9	
	KRY	7,553	07270		62.6	159.1	MD	MARSHALL 12.7	
			07281		50.0	171.8		COTTONWOOD 2.6	
		7,000	07283		47.4	173.4		NEW COTTONWOOD 3.6	
	A	3,070	07288		43.8	178.0		HANLEY FALLS 9.6	
	A	5,013	07297		34.2	187.6	GX	GRANITE FALLS 9.1	
			07306		25.2	196.7		MAYNARD 5.9	
		7,569	07312		19.2	202.6	CA	CLARA CITY 7.6	
		2,757	07320		11.6	210.2		RAYMOND 12.0	
	BJK RTXY		03092		0.0	222.2	W	WILLMAR	

BN Radio Channel No. 2 in service for Sioux City Area.

BN Radio Channel No. 1 in service on these subdivisions.

MINNESOTA DIVISION

WESTWARD	Rule 6(A) Signs	Length of Siding in Feet	Station Numbers	Line Segment	Mile Post Location	Distance From St. Cloud	4th Subdivn MAIN LINE		EASTWARD
							STATIONS		
							Office Calls		
	BIJK RTXY		00502		75.3	0.0	EA	ST. CLOUD 6.9	
			09070		82.0	6.9		ST. JOSEPH 8.1	
	6,996	09078			90.1	15.0		AVON 8.1	
		09084			96.3	21.1		ALBANY 6.3	
	6,513	09090			102.5	27.4		FREEPOR 5.9	
Y	4,138	09096			108.4	33.3		MELROSE 8.3	
	2,459	09104			118.7	41.6		SAUK CENTRE 5.8	
	6,592	09112			124.5	49.4		WEST UNION 5.8	
		09118			130.2	55.2		OSAKIS 5.7	
	6,528	09124			136.0	60.9		NELSON 5.6	
	4,278	09128	204		141.6	66.5		ALEXANDRIA 6.5	
	6,553	09136			148.1	73.0		GARFIELD 5.8	
	3,630	09141			153.8	78.8		BRANDON 5.1	
	5,881	09147			159.0	83.9		EVANSVILLE 8.9	
	5,697	09155			168.0	92.8		ASHBY 7.7	
	3,637	09163			175.7	100.5		DALTON 11.1	
	BJY	09175			186.7	111.6	GS	FERGUS FALLS 7.3	
	6,558	09183			194.9	119.9		CARLISLE 8.6	
	6,532	09191			203.6	128.5		ROTHSAY 6.8	
		09198			210.3	135.3		LAWNDALE 7.2	
					219.0				
	JRTY	6,734	09205		0.0	142.5	D	BARNESVILLE 8.0	
			53707	220	6.9	150.5		BAKER 6.6	
	6,496	53714			13.6	157.1		SABIN 7.8	
	IJY		00675		21.4	164.9		MOORHEAD JCT. 7.8	ABS

BN Radio Channel No. 2 in service for St. Cloud area.

MINNESOTA DIVISION

WESTWARD	Rule 6(A) Signs	Station Numbers	Line Segment	Mile Post Location	Distance From 7th Street	5th Subdivn MAIN LINE			EASTWARD	
						STATIONS				
						Office Calls				
	IJXY	00429		0.5	0.0	22	DT	7th STREET 0.6	ABS	
	IJXY			1.4	0.6			WM		WESTMINSTER ST. 3.8
	KXY	00433		5.1	4.4					MIDWAY 1.9
	IJMY	00435		7.0	6.3					ST. ANTHONY 1.3
	BKRXY	00436		8.4	7.6					UNION YARD 1.3
	JTY	00437		11.4	8.9			MPLS. JCT. 0.8		
	JXY		216	10.5	9.7			VAN BUREN ST. 0.8		

BN Radio Channel No. 2 in service for yard forces Dayton's Bluff area.  
BN Radio Channel No. 3 in service for yard forces Minneapolis area.  
BN Radio Channel No. 4 in service for yard forces Northtown area.

MINNESOTA DIVISION

WESTWARD	Rule 6(A) Signs	Length of Siding in Feet	Station Numbers	Line Segment	Mile Post Location	Distance From White Bear Lake	6th Subdivn MAIN LINE			EASTWARD
							STATIONS			
							Office Calls			
	JRY	5,942	51012		10.7	0.0	214		WHITE BEAR LAKE 0.9	ABS
	JTY		51011		9.8	0.9			M & D JCT. 5.2	
	JRUY	3,875	51006		4.6	6.1			GLOSTER 2.2	
	RY	2,237	51003		2.4	8.3			CLAYMONT 2.7	
	IJXY		00428		0.0	11.0			DIVISION STREET	

BN Radio Channel No. 2 in service for Dayton's Bluff area.

BN Radio Channel No. 1 in service for these subdivisions.

MINNESOTA DIVISION

WESTWARD	Rule 6(A) Signs	Station Numbers	FIRST CLASS		Line Segment	Mile Post Location	Distance From St. Croix Tower	7th Subdivn MAIN LINE STATIONS		FIRST CLASS		EASTWARD	
			7	9				Office Calls		8	10		
			NRPC Daily	NRPC Daily				NRPC Daily	NRPC Daily				
	IJX	00409			3	410.5	0.0	ST. CROIX TOWER					
<b>BETWEEN ST. CROIX TOWER AND DIVISION STREET CMS&amp;P RR TIMETABLE AND SPECIAL INSTRUCTIONS GOVERN.</b>													
	LJXY	00428			3	429.7	19.2	2MT	19.2 DIVISION STREET 0.6				
	LJXY	00429				430.0	19.8		7th STREET				
	IXY	51202			25	1.3	21.3	DT	1.5 MISSISSIPPI ST.				
	JXY	51203				2.0	21.5		0.2 TROUT BROOK JCT.				
	JXY	51204				2.3	21.9		0.4 SOO LINE JCT.				
	XY	51207				5.3	24.8		2.9 COMO SHOPS		ABS		
	AXY	51209				6.7	26.3		1.5 UNION				
	AXY	51210	11:15PM	8:01AM		8.3	27.8		1.5 PARK JCT.			A 5:40AM	A 8:55PM
	JTXY	51211	11:17	8:03		9.8	29.3		1.5 EAST MPLS		5:32	8:52	
	JXY		11:19	8:05		11.7	31.4		2.1 UNIVERSITY		5:29	8:49	
	JXY	00439	11:20	8:06		12.5	32.2		0.8 35th AVE.		5:28	8:48	
	ABLJK					13.9			0.4 NORTHTOWN		CTC		
	RTXY	00441	11:25	8:10	14.8	33.6	1.4 NORTHTOWN		5:25	8:47			
	XY	00442	11:27	8:12	15.5	35.4	1.8 INTERSTATE		5:22	8:45			
	LJKX	00448	A 11:33PM	A 8:20AM	21.1	41.1	DT	5.7 COON CREEK	Rule 251-254 ABS	5:15AM	8:40PM		

EXCEPT ON DOUBLE TRACK AND IN CTC TERRITORY, WHEN IN SERVICE, EASTWARD TRAINS ARE SUPERIOR TO WESTWARD TRAINS OF THE SAME CLASS.

BN Radio Channel No. 1 in service for road crews.  
 BN Radio Channel No. 2 in service for Dayton's Bluff area.  
 BN Radio Channel No. 3 in service for Minneapolis area.  
 BN Radio Channel No. 4 in service for Northtown area.

MINNESOTA DIVISION

WESTWARD	Rule 6(A) Signs	Length of Siding in Feet	Station Numbers	Line Segment	Mile Post Location	Distance From East Mpls.	8th Subdivn BRANCH LINE STATIONS		EASTWARD
							Office Calls		
							JTY	51211	
AY	51403	218	2.7	2.6	2.6 BELT LINE CROSSING				
	51405		4.6	4.5	1.9 ROSEVILLE				
JTY	51011		12.8	12.6	8.1 M & D JCT.				
<b>BETWEEN M &amp; D JCT. AND WHITE BEAR LAKE MINNESOTA SIXTH SUBDIVISION TIMETABLE, AND SPECIAL INSTRUCTIONS GOVERN.</b>									
JKRY	5,942	51012		0.0	13.5	WHITE BEAR LAKE			
U		50006	215	6.4	20.0	6.5 DULUTH JCT.			
		50008		8.6	22.3	2.3 SUMMIT			
BKRY		50012		12.8	26.2	3.9 STILLWATER			

BN Radio Channel No. 1 in service for road crews.  
 BN Radio Channel No. 3 in service for Minneapolis area.  
 BN Radio Channel No. 4 in service for Northtown area.

MINNESOTA DIVISION

WESTWARD	Rule 6(A) Signs	Station Numbers	Line Segment	Mile Post Location	Distance From University	9th Subdivn MAIN LINE STATIONS		EASTWARD
						Office Calls		
						JXY		
JTXY				1.9	1.9 VAN BUREN ST.		ABS	
IJTY		217	9.8	2.6	0.7 HARRISON STREET			
JY	03002		11.4	4.2	1.6 1st ST. NORTH			
JRY	03004	22	12.4	5.2	1.0 LYNDALE JCT.			

BN Radio Channel No. 1 in service for road crews.  
 BN Radio Channel No. 3 in service for Minneapolis area.  
 BN Radio Channel No. 4 in service for Northtown area.

MINNESOTA DIVISION

WESTWARD	Rule 6(A) Signs	Length of Siding in Feet	Station Numbers	Line Segment	Mile Post Location	Distance From Lyndale Jct.	10th Subdivn BRANCH LINE		EASTWARD
							STATIONS		
							Office Calls		
	JRY		03004	202	0.0	0.0	LYNDALE JCT. 1.6		
	JY		09001		1.7	1.6	M. W. JCT. 3.4		
	Y		09005		5.1	5.0	ROBBINSDALE 6.5		
	Y	4,730	09011		11.6	11.5	ST	OSSEO 9.0	
		5,190	09020		20.6	20.5	ROGERS 6.2		
		4,968	09027		26.9	26.7	ALBERTVILLE 8.5		
			09035	39.3	35.2	MONTICELLO			

BN Radio Channel No. 3 in service for Minneapolis area.

MINNESOTA DIVISION

WESTWARD	Rule 6(A) Signs	Station Numbers	Line Segment	Mile Post Location	Distance From Wayzata	11th Subdivn BRANCH LINE		EASTWARD
						STATIONS		
						Office Calls		
	J	03014	205	24.5	0.0	WAYZATA 6.6		
		51706		30.6	6.6	SPRING PARK 14.3		
		51721		45.0	20.9	MAYER 7.5		
		51728		52.5	28.4	LESTER PRAIRIE 16.0		
	RT	51744		68.5	44.4	HO	HUTCHINSON	

MINNESOTA DIVISION

WESTWARD	Rule 6(A) Signs	Station Numbers	Line Segment	Mile Post Location	Distance From Morris	13th Subdivn BRANCH LINE		EASTWARD
						STATIONS		
						Office Calls		
	BJK RTY	03148	201	0.0	0.0	MR	MORRIS 8.2	
		54507		7.2	8.2	ALBERTA 6.1		
		54513		13.3	14.3	CHOKIO 5.9		
		54519		19.2	20.2	JOHNSON 7.0		
	U	54526		26.2	27.2	GRACEVILLE 7.3		
		54532		32.1	33.1	BARRY 7.4		
		54539		39.4	40.4	BEARDSLEY 7.4		
	T	54546		46.9	47.8	BROWNS VALLEY		

BN Radio Channel No. 1 in service on these subdivisions.

MINNESOTA DIVISION

WESTWARD	Rule 6(A) Signs	Length of Siding in Feet	Station Numbers	Line Segment	Mile Post Location	Distance From Benson	12th Subdivn BRANCH LINE		EASTWARD
							STATIONS		
							Office Calls		
	JKRT		03123	200	0.0	0.0	BN	BENSON 7.9	
			54007		7.1	7.9	DANVERS 7.9		
			54015		15.0	15.8	HOLLOWAY 6.2		
	AJY	2,412	54021		21.2	22.0	AU	APPLETON 8.7	
			54030		29.9	30.7	LOUISBURG 6.5		
			54036		36.4	37.1	BA	BELLINGHAM 9.2	
			54046		45.5	46.3	NA	NASSAU 7.6	
			54057		57.1	58.0	LA BOLT 7.2		
			54065		64.8	65.6	STOCKHOLM 19.2		
			54072		72.0	72.8	SOUTH SHORE 9.9		
	BKRUY		54091	91.2	92.0	WN	WATERTOWN 6.3		
			54101	101.0	101.9	GROVER 6.9			
			54107	107.4	108.2	HAZEL 9.0			
			54114	114.8	115.1	VIENNA 12.1			
			54123	123.2	124.1	WILLOW LAKE 4.4			
			54135	135.3	136.2	BANCROFT 8.1			
			54140	139.7	140.6	OSCEOLA 13.2			
			54148	147.5	148.7	YALE 13.2			
	ABT		54161	161.0	161.9	HU	HURON		

MINNESOTA DIVISION

WESTWARD	Rule 6(A) Signs	Station Numbers	Line Segment	Mile Post Location	Distance From Geneseo Jct.	14th Subdivn BRANCH LINE		EASTWARD
						STATIONS		
						Office Calls		
	J	03186	209	0.0	0.0	ABERDEEN LINE JCT. 0.7		
	J	54601		0.6	0.0	G. N. JCT.		
<b>BETWEEN G. N. JCT. AND GENESEO JCT. SOO LINE RR TIMETABLE AND SPECIAL INSTRUCTIONS GOVERN.</b>								
	J	54645	209	43.3	0.0	GENESEO JCT. 0.9		
		54646		43.5	0.9	GENESEO 5.2		
		54651		48.7	6.1	CAYUGA 6.1		
		54657		54.8	12.2	RUTLAND 9.4		
		54666		64.1	21.6	HAVANA 6.5		
		54673		70.7	28.1	KIDDER 3.6		
	JY			74.2	31.7	BRITTON JCT. 10.7		
		54687		84.9	42.4	AMHERST 6.4		
		54694		91.3	48.8	CLAREMONT 10.8		
		54704		102.3	59.6	PUTNEY 17.0		
	ABKRT	54721	119.0	76.6	FN	ABERDEEN		

**MINNESOTA DIVISION**

**15th Subdiv  
BRANCH LINE**

WESTWARD	Rule 6(A) Signs	Station Numbers	Line Segment	Mile Post Location	Distance From Garretson	STATIONS		EASTWARD
						Office Calls		
	JKRTY	07204	198	128.3	0.0	JC	GARRETSON	
Y	54408	136.5		8.2			CORSON	
BJKR TUY	54418	145.7		17.4		SU	SIoux FALLS	
Y	54420	150.7		22.4			14th ST. YARD	

**MINNESOTA DIVISION**

**16th Subdiv  
BRANCH LINE**

WESTWARD	Rule 6(A) Signs	Station Numbers	Line Segment	Mile Post Location	Distance From East Wye Switch	STATIONS		EASTWARD
						Office Calls		
	JY	60021	2003	0.0	0.0	EAST WYE SWITCH		
	60607	6.6		6.6			WESTFIELD	
	60612	12.1		12.1			AKRON	
J		24.9		24.6			BERESFORD JCT.	
	60625	25.2		24.9			HAWARDEN	
	60635	34.5		34.5			HUDSON	
JRTY	60320	49.9		49.7			CANTON	
	60308	61.3		61.3			HARRISBURG	
	60300	69.5		69.3			SOUTH YARD	
BJKR TUY	54418	0.0		70.5		SU	(BN and CNW Crossings) SIoux FALLS	
J	54298	1.09		71.9			EAST JCT.	
J	54297	2.9		73.6			WEST JCT.	
	54281	20.6		91.7			COLTON	
	54274	28.2		99.3			CHESTER	
U	54266	325.2		106.9			WENTWORTH	
R	54807	334.6	114.3			MADISON		

**SPEED RESTRICTIONS  
ZONE — BETWEEN**

**MAXIMUM SPEEDS PERMITTED**

East Wye Switch and South Yard — MP 0.0 to MP 69.5	10 MPH
Sioux Falls and Colton — MP 0.0 to MP 3.0	10 MPH
East Jct. and Wentworth — MP 3 to MP 35.5	25 MPH
Chester and Wentworth — MP 35.5 to MP 35.8	10 MPH
Wentworth — over new connecting track	5 MPH
Wentworth and Madison — MP 325.26 to MP 334.33	25 MPH
Wentworth and Madison — MP 334.33 to MP 334.6	10 MPH

RULE 83(B) does not apply at East Wye Switch or Beresford Jct.

RULE 99 — Unless otherwise provided, protection against following trains is not necessary. When required to flag distance will be one mile.

BN Radio Channel No. 2 in service for yard forces Sioux City area.

**MINNESOTA DIVISION**

**17th Subdiv  
BRANCH LINE**

WESTWARD	Rule 6(A) Signs	Length of Siding in Feet	Station Numbers	Line Segment	Mile Post Location	Distance From St. Cloud	STATIONS		EASTWARD
							Office Calls		
	BJKR TXY			00502		0.0	0.0	EA	
					9.0	10.1			ROCKVILLE
					13.8	15.1			COLD SPRING
					18.3	19.6			RICHMOND
AM				203	29.9	31.2			PAYNESVILLE
					42.0	43.3			NEW LONDON
					46.3	47.5			SPICER
BJKR TXY			03092		55.0	57.6		W	WILLMAR

BN Radio Channel No. 2 in service for St. Cloud area.

**MINNESOTA DIVISION**

**18th Subdiv  
BRANCH LINE**

WESTWARD	Rule 6(A) Signs	Station Numbers	Line Segment	Mile Post Location	Distance From Starbuck	STATIONS		EASTWARD
						Office Calls		
		53568	208		67.7	0.0		
	53578				78.0	10.3		CYRUS
BJK RTY	03148				87.1	19.4	MR	MORRIS

BN Radio Channel No. 1 in service on these Subdivisions.

8

## MINNESOTA DIVISION

WEST WARD	Rule 6(A) Signs	Length of Siding in Feet	Station Numbers	Line Segment	Mile Post Location	Distance From Little Falls	19th Subdivn BRANCH LINE			EAST WARD
							STATIONS			
							Office Calls			
	BJK RTY		00533	207	105.3	0.0	FA	LITTLE FALLS		
			52506		110.3	5.6		5.6 BELLE PRAIRIE		
	T		52508		112.6	7.8		2.2 CAMP RIPLEY JCT.		

## MINNESOTA DIVISION

WEST WARD	Rule 6(A) Signs	Length of Siding in Feet	Station Numbers	Line Segment	Mile Post Location	Distance From Long Prairie	20th Subdivn BRANCH LINE			EAST WARD
							STATIONS			
							Office Calls			
			53018	210	17.8	0.0		LONG PRAIRIE		
			53026		26.0	7.9		7.9 BROWERVILLE		
			53032		31.4	13.2		5.3 CLARISSA		
			53036		36.1	17.9		4.7 EAGLE BEND		
			53044		43.6	25.4		7.5 BERTHA		
	JXY		00585		55.7	37.6		12.2 WADENA	WA	
			53070		70.0	51.9		14.3 SEBEKA		
			53079		78.7	60.6		8.7 MENAHGA		
			53091		90.9	72.8		12.2 PARK RAPIDS	J	

## MINNESOTA DIVISION

WEST WARD	Rule 6(A) Signs	Station Numbers	Line Segment	Mile Post Location	Distance From Brecken- Ridge	21st Subdivn BRANCH LINE			EAST WARD	
							STATIONS			
							Office Calls			
	BIJK RTY	03204	564	74.7	0.0	BR	BRECKENRIDGE			
<b>BETWEEN BRECKENRIDGE AND WAHPETON JCT. DAKOTA SECOND SUBDIVISION TIMETABLE, AND SPECIAL INSTRUCTIONS GOVERN.</b>										
	JY	03209	221	75.7	1.7		1.7 WAHPETON JCT.			
		53291		88.6	14.0		12.3 MOORETON			
		53297		94.6	20.0		6.0 BARNEY			
	U	53303		100.8	26.2		6.2 WYNDMERE			
		53312		110.7	36.0		9.8 DE LAMERE			
	T	53319		116.7	42.1		6.1 MILNOR			
		53322		122.3	47.6		5.5 HOVING			
		53329		127.1	52.5		4.9 GWINNER			
		53336		134.2	59.5		7.0 STIRUM			
		53343		141.7	67.0		7.5 CRETE			
	BJRTY	56969		149.6	75.0		8.0 OAKES	KS		

## MINNESOTA DIVISION

WEST WARD	Rule 6(A) Signs	Station Numbers	Line Segment	Mile Post Location	Distance From Ludden Jct.	22nd Subdivn BRANCH LINE			EAST WARD	
							STATIONS			
							Office Calls			
	J	54932	273	29.5	0.0		LUDDEN JCT.			
		54935		34.7	5.3		5.3 GUELPH			
		54949		49.2	20.0		14.7 ELLEDALE			

## MINNESOTA DIVISION

WEST WARD	Rule 6(A) Signs	Station Numbers	Line Segment	Mile Post Location	Distance From Battle Lake	23rd Subdivn BRANCH LINE			EAST WARD	
							STATIONS			
							Office Calls			
	Y	53233	221	31.4	0.0		BATTLE LAKE			
	Y	53241		39.4	7.9		7.9 UNDERWOOD			
	JRY	09175		49.6	18.2	GS	10.3 FERGUS FALLS			

## MINNESOTA DIVISION

WEST WARD	Rule 6(A) Signs	Station Numbers	Line Segment	Mile Post Location	Distance From Fergus Falls	24th Subdivn BRANCH LINE			EAST WARD	
							STATIONS			
							Office Calls			
	JRY	09175	221	49.6		GS	FERGUS FALLS			
	Y	53263		61.3	12.3		12.3 FOXHOME			

BN Radio Channel No. 1 in service on these subdivisions.



MINNESOTA DIVISION

25th Subdivn  
BRANCH LINE

STATIONS  
Office Calls

Rule 6(A) Signs	Length of Siding in Feet	Station Numbers	Line Segment	Mile Post Location	Distance From Sioux City
Y		60000	2001	513.1	0.0
Y		60006		519.1	6.0
		60013		525.6	12.5
JY		60021		533.4	20.2
RY		60022		534.0	20.9
		60030		542.6	29.5
		60035		548.3	35.2
		60041		556.8	43.7
		60050		562.9	49.8
JY	3,300	60063		575.1	62.0
Y		60069		580.7	67.6
		60073		584.3	71.2
		60083		590.9	77.8
	2,250	60090		602.3	89.2
		60097		608.9	95.8
	1,812	60104		615.9	102.8
		60109		621.4	108.3
	2,000	60116		627.9	114.8
		60121		633.4	120.3
		60127		638.5	125.4
JRY		60399	650.0	136.9	
		60406	657.5	144.4	
		60414	665.0	151.9	
	2,042	60427	678.2	165.1	
		60437	687.9	174.8	
		60445	696.1	183.0	
ARU		60454	704.6	191.5	
		60466	717.0	203.9	
		60477	727.7	214.6	
AU	4,552	60487	737.8	224.7	
		60495	746.0	232.9	
		60506	757.0	243.9	
		60512	762.8	249.7	
		60518	768.7	255.6	
A			775.6	262.5	
JRY		54721	778.6	265.5	

SIoux CITY (East Yard) 6.0
North SIoux CITY 6.5
JEFFERSON 7.7
EAST WYE SWITCH 0.7
ELK POINT 8.6
BURBANK 5.7
VERMILLION 8.5
MECKLING 6.1
GAYVILLE 12.2
YANKTON 5.6
NAPA 3.6
UTICA 6.6
LESTERVILLE 11.4
SCOTLAND 6.6
KAYLOR 6.5
TRIPP 6.5
BEARDSLEY 6.5
PARKSTON 5.5
DIMOCK 5.1
ETHAN 11.5
MITCHELL 7.5
LOOMIS 7.5
LETCHER 13.2
WOONSOCKET 9.7
ALPENA 8.2
VIRGIL 8.5
WOLSEY (C&NW CROSSING) 12.4
BONILLA 10.7
TULARE 10.1
(C&NW CROSSING) REDFIELD 8.2
ASHTON 11.0
MELLETTTE 5.8
DUXBURY 5.9
WARNER 6.9
(C&NW CROSSING) 3.0
ABERDEEN YARD

SPEED RESTRICTIONS ZONE — BETWEEN	MAXIMUM SPEED PERMITTED
Sioux City & Wolsey	10 MPH
Wolsey & Aberdeen Yard	25 MPH

RULE 99 — Unless otherwise provided, protection against following trains is not necessary. When required to flag distance will be one-fourth mile.

RULE 83(B) does not apply at Mitchell or Wolsey.

BN Radio Channel No. 2 in service for yard forces Sioux City area.

MINNESOTA DIVISION

26th Subdivn  
BRANCH LINE

STATIONS  
Office Calls

Rule 6(A) Signs	Station Numbers	Line Segment	Mile Post Location	Distance From Beresford Jct.
J			24.9	0.0
	60686	2021		7.7
	60698			16.9

BERESFORD JCT. 7.7
ALCESTER
BERESFORD

MAXIMUM SPEED 10 MPH  
RULE 83(B) does not apply at Beresford Jct.

MINNESOTA DIVISION

27th Subdivn  
BRANCH LINE

STATIONS  
Office Calls

Rule 6(A) Signs	Length of Siding in Feet	Station Numbers	Line Segment	Mile Post Location	Distance From Canton
JRTY		60320	2002	294.7	0.0
		60328		303.7	9.0
		60336		310.5	15.8
		60341		315.4	20.7
		60349		323.2	28.5
	2,221	60355		329.7	35.0
		60369		337.6	42.9
		60370		344.7	50.0
	7,763	60377		351.7	57.0
	1,761	60386		360.6	65.9
JRY		60399		373.9	79.1
		60144		379.9	85.1
		60150		385.7	90.9
		60161		397.0	102.2
		60172		408.4	113.6
		60184	420.9	126.1	
		60196	432.5	137.7	
RY		60204	440.5	145.7	

CANTON 9.0
WORTHINGTON 6.8
LENNOX 4.9
CHANCELLOR 7.8
PARKER 7.9
MARION 7.1
DOLTON 7.0
BRIDGEWATER 8.9
EMERY 13.3
ALEXANDRIA 6.0
MITCHELL 6.0
BETTS 5.8
MT. VERNON 11.3
PLANKINTON 11.4
WHITE LAKE 12.5
KIMBALL 11.6
PUKWANA 8.0
CHAMBERLAIN

MAXIMUM SPEED 10 MPH.

RULE 99 — Unless otherwise provided, protection against following trains is not necessary. When required to flag distance will be one-fourth mile.

RULE 83(B) does not apply at Canton or Mitchell.

BN Radio Channel No. 1 in service on these Subdivisions.

MINNESOTA DIVISION

28th Subdiv  
MAIN LINE

W E S T W A R D	Rule (A) Signs	Length of Siding in Feet	Station Numbers	Line Segment	Mile Post Location	Distance From Stateline	E A S T W A R D	
							STATIONS	Office Calls
	JR				600.7	0.0	STATELINE	
			08202		602.2	1.5	1.5 BIG STONE	CTC
	BJK RT	15.087	08211		611.1	10.4	8.9 B MILBANK	
	T	10.559	08233	2004	633.2	32.5	22.1 H SUMMIT	
		8.470	08257		657.2	56.5	24.0 WS WEBSTER	
	T	12.142	08268		668.5	67.8	11.3 BR BRISTOL	
		9.302	08278		678.1	81.4	13.6 ANDOVER	
		11.939	08288		687.9	91.2	9.8 RO GROTON	ABS
	AY				706.2	109.5	18.3 (BN & CNW CROSSING)	
	BKRY		54721		707.0	110.3	0.8 R N ABERDEEN	
	JTY				707.4	110.7	0.4 ABERDEEN YARD	
		9.446	08320		720.1	123.4	12.7 MINA	
		3.850	08328		728.2	131.5	8.1 CRAVEN	
			08333		733.3	136.6	5.1 IPSWICH	
		7.834	08341		741.6	144.9	8.3 BEEBE	
	T		08349		748.6	151.9	7.0 RC ROSCOE	CTC
		7.758	08357		757.2	160.5	8.6 GRETNA	
		7.429	08370		770.9	174.2	13.7 ALAMO	
			08377		776.6	179.9	5.7 JAVA JCT.	
		7.673	08384	2005	784.2	187.5	7.6 SELBY	
		7.970	08396		796.3	199.6	12.1 GLENHAM	
	BKR TY	10.361	08405	See Note Below	806.0	209.3	9.7 MB MOBRIDGE	

NOTE: Mile Posts between Bristol & Andover are numbered as follows:

- MP 676
- MP 676 A
- MP 676 B
- MP 676 C
- MP 676 D
- MP 677 etc.

BN Radio Channel No. 1 in service on this Subdivision

MINNESOTA DIVISION  
(STATELINE-MOBRIDGE)  
TWENTY-EIGHTH SUBDIVISION

SPEED RESTRICTIONS  
ZONE — BETWEEN

MAXIMUM SPEED PERMITTED

1. Stateline and Mobridge ..... 30 MPH
- All Trains — Through all sidings and turn-outs ..... 10 MPH
- Aberdeen, C&NW and BN crossings ..... 20 MPH
- Aberdeen, over Main and Kline Street crossings ..... 10 MPH
- Aberdeen, between C&NW-BN crossing & west switch of yard ..... 10 MPH
- Aberdeen, Over Third and Sixth Avenue street crossing ..... 10 MPH

2. Bridge, Engine and Heavy Car Restrictions:  
Maximum weight restrictions loaded freight cars ..... 263,000 lbs.
3. Train Register Exceptions —  
At Milbank and Moberg-Through trains will register when directed by train order.
4. Clearance Provisions and Exceptions Rule 83(B)-  
At Moberg-Rule 83(B) does not apply for through trains.  
In CTC territory — Rule 83(B) will not apply at Intermediate Stations when so authorized by the train dispatcher.
5. Rule 99 - When flagging is required, distance will be 1 mile.
6. ABS is in service between the west switch at Summit (MP 633.5), and the west switch at Aberdeen Yard (MP 707.4).
7. CTC is in service between Stateline (MP 600.7) and the west switch at Summit (MP 633.5), and between the west switch at Aberdeen Yard (MP 707.4) and the west switch at Moberg (MP 806.0).
8. Between Aberdeen and Moberg - Dual Control switches located as follows:  
Aberdeen Yard — West end  
Glenham — East and West ends of siding  
Moberg — West end yard
9. In CTC territory between the west switch at Aberdeen (MP 707.4) and the west switch at Moberg (MP 806.0) — Rule 268A does not apply.
10. Between Stateline and Moberg —  
CMSTP&P railroad signal aspects and indications in effect between Stateline (MP 600.7) and Moberg (MP 806.0). Refer to pages 100 through 105, and 120 and 121 of Consolidated Code of Operating Rules.
11. Freight trains over 100 tons per operative brake are permitted only on the following tracks:  
Main track 28th Subdivision  
No. 1 track at Aberdeen  
Sidings at Andover, Bristol, Summit, Milbank and Plant Loop-Big Stone.
12. Aberdeen Yard — Crossover switches leading from Tracks 1 and 2 must be left lined for through movements on those tracks.  
Normal position for south leg of wye switch from the drill track north of the overpass is lined for through movement on the drill track.  
At Sixth Ave., color light type indicators located adjacent to all tracks on both sides of the street crossing governing train and engine movements over crossings are in service. When yellow is displayed, traffic signals are at stop and rail movements may be made over crossings. When red is displayed the following will govern: Pushbuttons for manual control of the traffic signals are located on masts of the indicators. When indicator displays red after a train has approached to within 50 feet of the crossing a member of the crew must operate the button. If indicator continues to display red, movement must be made as per Rule 103.
13. Spring switches located at: Webster - East end  
Bristol - East end  
Groton - East and West end

Spring Switches - Movement in facing point direction over a spring switch not equipped with a facing point lock must not exceed 25 MPH. When switch is equipped with a facing point lock, movement may be made at normal speed. If switch is lined for the turnout, the allowable turnout speed must be observed. Movement in trailing point direction over a spring switch on track for which the switch is lined, may be made at normal speed.

## INDUSTRIAL TRACKS AND OTHER TRACKS NOT SHOWN AS STATIONS IN TIME TABLE

Name	Location	Capacity Cars	Switch Opens	Name	Location	Capacity Cars	Switch Opens
<b>First Subdivision</b>				<b>Seventh Subdivision</b>			
<b>On Westward Track</b>				<b>On Westward Track</b>			
Prestressed Concrete, Inc.				Totino's Spur			
Spur				2.6 miles west of Northtown			
Minnesota Sawdust Spur				10			
3.6 miles west of Anoka				13			
5				East			
00498 Reformatory				Northern States Power Co.			
8.7 miles west of Clear Lake				Spur			
13				6.5 miles west of Northtown			
51810 Zimmerman				10			
9.5 miles west of Elk River				13			
23				East			
St. Paul Sand and Gravel				Kinas Spur			
2.5 miles west of Elk River				7.1 miles west of Northtown			
60				14			
Marv's Bldg. Center				1			
1.6 miles east of Princeton				8			
8				West			
Offutt & Son Potato Spur				00446 Toews Finishing Ind.			
0.4 mile west of Glyndon				2.4 miles east of Coon Creek			
19				4			
				00445 Barry Flower Co. Spur			
				3.0 miles east of Coon Creek			
				3			
				East			
<b>On Eastward Track</b>				<b>Eighth Subdivision</b>			
00632 Richards Spur				50004 Mahtomedi			
3.5 miles west of Detroit Lakes				3.6 miles west of White			
100				Bear Lake			
9							
00486 Hayes Spur							
2.6 miles east of Clear Lake							
9							
East							
NSP Spur							
5.5 miles east of Clear Lake							
Yard							
00485 Edling Spur							
4.3 miles east of Clear Lake							
10							
East							
00464 REA Spur							
0.8 mile east of Elk River							
30							
East							
00459 Pyrofax Gas Corp. Spur							
5.8 miles east of Elk River							
3							
East							
00457 Char Galt Mfg. Co. Spur							
(Tech. Education Center)							
7.8 miles east of Elk River							
15							
East							
00456 L. H. Bolduc Co. Inc.							
8.8 miles east of Elk River							
15							
East							
00455 Cornelius Co.							
9.8 miles east of Elk River							
8							
East							
<b>Second Subdivision</b>				<b>Tenth Subdivision</b>			
03018 Long Lake				09007 Crystal Lumber Co. Spur			
3.1 miles west of Wayzata				1.5 miles west of Robbinsdale			
22				2			
West				West			
03036 Montrose				09009 Midway Platt Co. Spur			
6.7 miles west of Delano				2.5 miles east of Osseo			
23				11			
Both				East			
Co-op Spur				09010 Osseo Concrete Co. Spur			
1.7 miles west of Murdoch				1.5 miles east of Osseo			
23				10			
West				West			
03178 Charlesville				09013 North Star Concrete Co. Spur			
6.4 miles west of Norcross				0.9 mile west of Osseo			
24				14			
Both				West			
Lampert Lumber Co.				09018 Hennepin Coop Feed			
2.0 miles east Willmar				Exchange Spur			
23				2.0 miles east of Rogers			
East				6			
				East			
				09021 K&K Mfg. Co. Spur			
				0.1 mile west of Rogers			
				7			
				West			
				09022 Rogers Hdwe. & Lbr. Co.			
				0.3 mile west of Rogers			
				7			
				East			
				09038 Northern States Power			
				Co. Spur			
				3.0 miles west of Monticello			
				35			
				East			
<b>Third Subdivision</b>				<b>Eleventh Subdivision</b>			
07326 Priam				51708 Cox Bros. Spur			
5.9 miles east of Willmar				0.5 mile west of Spring Park			
20				2			
East				West			
07303 Asbury				51709 Mound			
3.7 miles east of Maynard				1.9 miles west of Spring Park			
39				43			
Both				Both			
07274 Green Valley				51713 St. Bonifacius			
5.3 miles west of Marshall				6.4 miles west of Spring Park			
34				34			
Both				Both			
07268 Read-Mix and Oil Spur				51724 New Germany			
0.5 mile east of Marshall				3.8 miles west of Mayer			
6				27			
West				Both			
07267 Appleton Silo Co. Spur				51729 Cominco American Inc. Spur			
0.7 mile east of Marshall				0.2 mil west of Lester Prairie			
5				8			
West				East			
07265 Lyon Farm Center Inc.				51736 Silver Lake			
1.5 miles east of Marshall				7.8 miles west of Lester Prairie			
6				23			
West				West			
07262 Lynd							
6.7 miles east of Marshall							
13							
East							
07250 Southwestern Minnesota Dairy							
Ass'n Spur							
1.0 mile east of Russell							
12							
East							
07224 Jasper Grain Track							
4.1 miles east of Ihlen							
54							
Both							
07223 Cargill Grain Track							
2.78 miles east of Pipestone							
55							
Both							
07207 Sherman							
3.3 miles west of Garretson							
54							
Both							
07159 Perkins							
8.9 miles east of Doon							
18							
West							
Sioux Preme Packing Co.							
3.2 miles east of Sioux Center							
6							
East							
07132 West Le Mars Feed and							
Grain Co.							
7.1 miles east of Struble							
6							
East							
07132 Northwest Iowa Farm							
Bureau Service Co.							
7.1 miles east of Struble							
8							
West							
<b>Fourth Subdivision</b>				<b>Twelfth Subdivision</b>			
09072 Collegeville				54051 Albee			
2.7 miles west of St. Joseph				5.4 miles west of Nassau			
6				35			
West				Both			
09094 Kraft Foods				54082 Hallet Construction Spur			
0.7 mile east of Depot Melrose				8.4 miles west of South Shore			
12				20			
East				West			
09173 Midland Coop. Ind.				54085 Rauville			
1.3 miles east of Fergus Falls				13.2 miles west of South Shore			
6				34			
West				Both			
09172 Otter Tail Coop. Oils Inc.							
1.8 miles east of Fergus Falls							
9							
East							
09177 Great Plains Natural Gas							
Co. Spur							
1.2 miles west of Depot							
Fergus Falls							
8							
West							
Asylum Spur							
1.3 miles west of Depot							
Fergus Falls							
69							
West							
Farmland Industry Spur							
4.8 miles west of Barnesville							
12							
Both							
09213 Downer							
7.8 miles west of Barnesville							
39							
Both							
53704 Gary L. Smith Potato Whse.							
2.5 miles east of Baker							
8							
East							
53705 Butenhoff and Hanson							
Potato Warehouse							
2.0 miles east of Baker							
18							
East							
53706 Chester Posschl Potato							
Warehouse Spur							
0.4 miles east of Depot Baker							
8							
East							
53717 Agsco Inc. Spur							
3.5 miles west of Depot Sabin							
9							
East							
53220 Farbo-Moorhead Asphalt Co.							
0.7 miles east of Moorhead Jct.							
7							
West							
<b>Sixth Subdivision</b>				<b>Fifteenth Subdivision</b>			
51008 Maplewood				54408 Corson Grain Track			
2 miles west of Gloster				8.2 miles west of Garretson			
26				41			
East				Both			
				54409 Pathfinder Spur			
				1.0 miles west of Corson			
				28			
				West			
				54414 Lawrence Spur			
				6.0 miles west of Corson			
				45			
				Both			
				54415 Crampton Spur			
				7.5 miles west of Corson			
				22			
				West			
				<b>Sixteenth Subdivision</b>			
				54293 Crooks			
				4.0 miles west of West Jct.			
				14			
				Both			
				54287 Lyons			
				10.0 miles west of West Jct.			
				15			
				Both			
				60641 Fairview, SD			
				8.5 miles east of Canton			
				7			
				East			
				60619 Chatsworth, IA			
				6.1 miles east of Hawarden			
				7			
				East			
				<b>Seventeenth Subdivision</b>			
				09050 Clearwater			
				12.6 miles east of St. Cloud			
				83			
				Both			
				09056 Central Bi-Products Co. Spur			
				6.9 miles east of St. Cloud			
				5			
				East			
				09059 Tileston Mill Spur			
				3.5 miles east of St. Cloud			
				11			
				East			
				07385 Empire Quarry Spur			
				3.1 miles west of St. Cloud			
				82			
				East			
				07384 North Star Granite Corp. Spur			
				4.9 miles west of St. Cloud			
				40			
				West			
				07383 Cold Spring Granite Spur			
				5.7 miles west of St. Cloud			
				10			
				East			
				07364 Roscoe			
				6.2 miles west of Richmond			
				34			
				East			
				07354 Moorman Mfg. Co.			
				4.9 miles west of Paynesville			
				14			
				West			
				07350 New London Materials and			
				Construction Co.			
				8.4 miles west of Paynesville			
				34			
				Both			

## MINNESOTA DIVISION

INDUSTRIAL TRACKS AND OTHER TRACKS  
NOT SHOWN AS STATIONS IN TIME TABLE

Name	Location	Capacity Cars	Switch Opens
<b>Seventeenth Subdivision, Cont.</b>			
07347	Trinity Steel Co. ....	1.2 miles east of New London ...	6 East
07348	New London Gravel Pit .....	1.7 miles east of New London ...	250 Both
<b>Eighteenth Subdivision</b>			
53586	State A&R School Spur .....	1.0 mile east of Morris .....	4 East
53567	Starbuck Fuel & Iron .....	0.4 mile east of Starbuck .....	6
<b>Nineteenth Subdivision</b>			
52503	Crestliner, Inc. ....	1.9 miles west of Little Falls ...	8
52504	Hennepin Paper Spur .....	3.3 miles west of Little Falls ...	25 East
<b>Twentieth Subdivision</b>			
53048	Hewitt .....	8.2 miles east of Wadena .....	6 East
53020	Central By Products .....	6.3 miles east of Browerville ...	35 East
53021	Midland Co-op. Spur .....	6.3 miles east of Browerville ...	5 East
53071	Land O'Lakes Creamery Spur ..	0.5 mile west of Sebeka .....	19 West
<b>Twenty-First Subdivision</b>			
	Streich Farms Spur .....	0.8 mile east of Oakes .....	11 East
<b>Twenty-Third Subdivision</b>			
53250	Hoot Lake .....	0.8 mile east of Fergus Falls ...	60 West
<b>Twenty-Fourth Subdivision</b>			
53253	Fergus Dairy Co-op .....	0.8 mile west of Fergus Falls ...	17 West
53253	Fergus Foundry Spur .....	0.9 mile west of Fergus Falls ...	15 West
53254	Packing House .....	1.2 miles west of Fergus Falls ...	3 West
53254	Fergus Falls Rendering Co. ....	1.2 miles west of Fergus Falls ...	3 East
53258	French .....	6.4 miles west of Fergus Falls ...	13 West
	Midland Coop Spur .....	6.3 miles west of Fergus Falls ...	6 West
<b>Twenty-Eighth Subdivision</b>			
08218	Twin Brooks .....	7.2 miles west of Milbank .....	4 East
08226	Marvin .....	7.7 miles west of Twin Brooks ...	6 West
08237	Jackson .....	11.0 miles west of Marvin .....	87 East
08241	Ortley .....	3.8 miles west of Jackson .....	25 West
08246	Waubay .....	5.4 miles west of Ortley .....	45 Both
08264	Holmquist .....	6.4 miles west of Webster .....	42 West
08299	Bath .....	11.1 miles west of Groton .....	19 Both
08348	Orient Line Jct. Wye .....	5.5 miles west of Beebe .....	34 Both
08364	Bowdle .....	6.7 miles west of Gretna .....	44 Both
08392	Sitka .....	8.0 miles west of Selby .....	46 East

MINNESOTA DIVISION  
LINE SEGMENT NUMBERS

## TWIN CITIES TERMINAL LINE SEGMENTS

Line Segment	Minneapolis	Limits
467	Northtown Yard	Mississippi Street - University Avenue
530	Grove Yard	Northtown Jct. - 27th Avenue N.E.
531	Minneapolis Jct. Yard	University Avenue - Main Street N.E. - 14th Avenue S.E.
533	Lyndale Yard	3rd Avenue South - 1st Street North - Highway 100
534	Union Yard	14th Avenue S.E. - Raymond Avenue
535	East Minneapolis Yard	University Avenue - Talmage Avenue
536	Park Jct. Yard	Talmage Avenue - Highway 280
537	Northtown WFE	
<b>St. Paul</b>		
540	Midway Yard	Raymond Avenue - Lexington Avenue
541	Como Shops Yard	Highway 280 - Maryland Avenue and CB&Q Connection
542	Dale Street Shop Yard	Lexington Avenue - Como Avenue
543	Como Yard	Como Avenue - Rice Street
544	Jackson Street Shop Yard	Rice Street - Jackson Street
545	Mississippi Street WFE Yard	Jackson Street - Mississippi Street
546	Daytons Bluff Yard	Oakland Tower - Mississippi Street, Maryland Street, Gloster
547	Stillwater (Minnesota) Yard	Stillwater

## OTHER YARD LINE SEGMENTS

Line Segment	Yard
548	Watertown Yard
549	Sioux City (EX-Milw)
550	St. Cloud Shop Yard
551	St. Cloud Yards
552	Wilmar
553	Staples
554	Sioux Falls Yard
555	Sioux City Yard
556	Sioux City Terminal Co.
557	Wilmar WFE
558	Ellendale (EX-Milw)
559	Pipestone (EX-Milw Yard)
2011	Mitchell Yard
2012	Sioux City Yard (East Yard)
2004	Ortonville - MP 600 to MP 680.5
2005	MP680.5 to Moberge MP 806
2013	Aberdeen Yard

NOTE: Mile Posts between Bristol and Andover are numbered as follows:  
MP 676 MP 676 C  
MP 676 A MP 676 D  
MP 676 B MP 677 etc.

For Line Segment purposes ONLY, the following in effect:  
MP 676 A equals 677  
MP 676 B equals 678  
MP 676 C equals 679  
MP 676 D equals 680  
(Break point here at MP 680.5 or .5 mile west of MP 676 D.)

## BALLAST PITS

Line Segment	Limits
578	Appleton
579	Granite Falls
580	Russell
581	St. Cloud
586	Ortonville

## OTHER ROAD LINE SEGMENTS

Line Segment	Limits	Mileposts
202	Monticello - St. Cloud	39.3 to 58.9
216	St. Anthony - Minneapolis Jct.	7.0 to 9.6
216	University - Northtown	11.7 to 12.3
222	Hopkins Jct. - Hopkins	0.0 to 3.9
32	Barnesville Jct. - Downer	2.1 to 5.4

**FREIGHT TRAIN SCHEDULES**  
(For Information Only)

**MINNESOTA DIVISION**

**WESTWARD**

Train No.	ST. CROIX TOWER	DAYTONS BLUFF		MINNEAPOLIS Northtown		COON CREEK	STAPLES		DIL-WORTH
	Leave	Arrive	Leave	Arrive	Leave	Leave	Arrive	Leave	Arrive
BPX	3:35PM			5:15PM	6:45PM	7:10PM	9:40PM	9:45PM	12:45AM
3	10:45PM			12:05AM	1:25AM	1:50AM	4:10AM	4:15AM	6:15AM
23	8:15AM			9:35AM	10:55AM	11:20AM	1:40PM	1:45PM	3:45PM
57	9:30AM			11:45AM	2:00PM	2:25PM	5:25PM	5:30PM	8:10PM
83					11:00PM	11:30PM	3:30AM	3:40AM	6:30AM
85	6:40AM			9:25AM	2:25PM	2:50PM	5:35PM	6:05PM	8:40PM
CHB	6:40AM			9:25AM	2:25PM	2:50PM	5:35PM	5:40PM	8:10PM
97	2:45PM			4:25PM	10:30PM	10:55PM	1:40AM	1:45AM	4:15AM
197	12:25AM			2:05AM					

Train No.	MINNEAPOLIS Northtown	LYNDALE		WILLMAR		BRECKENRIDGE
	Leave	Arrive	Leave	Arrive	Leave	Arrive
81	6:00AM		8:30AM	11:30AM	2:30PM	6:00PM
131					3:00AM	6:30AM

Train No.	MINNEAPOLIS Northtown	LYNDALE		WILLMAR		SIOUX CITY	
	Leave	Arrive	Leave	Arrive	Leave	Arrive	Leave
190	11:00PM			3:00AM	4:00AM	1:00PM	3:00PM

**EASTWARD**

Train No.	DIL-WORTH	STAPLES		COON CREEK	NORTHTOWN		MIDWAY		DAYTONS BLUFF		ST. CROIX TOWER
	Leave	Arrive	Leave	Arrive	Arrive	Leave	Arrive	Leave	Arrive	Leave	Arrive
PBF	1:30AM	3:35AM	3:40AM	6:10AM	6:45AM	8:45AM					10:30AM
4	1:00AM	3:25AM	3:30AM	6:05AM	6:35AM	7:35AM					8:55AM
58						10:30PM					12:45AM
80	4:50AM	7:30AM	7:35AM	10:10AM	11:00AM	1:10PM					2:55PM
82	10:40PM	12:55AM	1:00AM	3:15AM	3:55AM	10:10AM					11:55AM
84	6:50PM	9:40PM	9:45PM	12:35AM	1:25AM						
86	3:45PM	6:30PM	6:40PM	9:40PM	10:10PM						
88	5:05PM	7:55PM	8:00PM		11:40PM						
98						12:01PM					2:15PM
182	11:35PM	1:50AM	1:55AM	4:20AM	4:50AM	10:45AM					12:30PM

Train No.	BRECKENRIDGE	WILLMAR		LYNDALE		MINNEAPOLIS Northtown	SIOUX CITY		DAYTONS BLUFF		ST. CROIX TOWER
	Leave	Arrive	Leave	Arrive	Leave	Arrive	Arrive	Leave	Arrive	Leave	Arrive
132	8:15PM	11:30PM									
172	3:15PM	6:15PM	7:45PM	11:00PM	11:30PM	1:00AM					

Train No.	SIOUX CITY		WILLMAR		LYNDALE		MINNEAPOLIS Northtown	BRECKENRIDGE	
	Arrive	Leave	Arrive	Leave	Arrive	Leave	Arrive	Arrive	Leave
191	11:30AM	1:00PM	10:30PM	11:00PM			3:00AM		

WISCONSIN DIVISION

WESTWARD	Rule 6(A) Signs	Length of Siding in Feet	Station Numbers	FIRST CLASS		Line Segment	Mile Post Location	Distance From Boylston	1st Subdivn MAIN LINE STATIONS Office Calls		EASTWARD
				761					760		
				NRPC 10 Daily					NRPC 9 Daily		
	IJTX		05013		6:29PM		13.3	0.0		BOYLSTON	A 10:25AM
		6,118	06112		6:44		24.5	11.3		11.3 FOXBORO	10:14
		7,129	06100		6:56		36.6	23.3		12.0 NICKERSON	10:04
		5,690	06088		7:07		48.9	35.5		12.2 BRUNO	9:54
		6,957	06080				57.2	43.9		8.4 ASKOV	
	Y	7,685	06074	s	7:22		63.1	49.8		5.9 SANDSTONE	s 9:40
	ABJY	7,417	06065		7:33		71.9	58.5	HN	8.7 HINCKLEY	9:26
	JY	8,553	06057			28	80.1	66.8		8.3 BROOK PARK	
		5,557	06046		7:51		91.3	78.0		ABS	9:06
			06040				96.6	83.3		5.3 GRASSON	
		5,400	06029	s	8:10		107.4	94.1	CG	10.8 BRAHAM	s 8:50
		4,958	06018		8:22		119.0	105.8		11.7 CAMBRIDGE	8:32
		5,145	06006		8:35		131.0	117.7		11.9 BETHEL	8:20
	LJR		00448	A	8:40PM		136.9	123.6	CN	5.9 ANDOVER	8:15AM
										5.9 COON CREEK	

EASTWARD TRAINS ARE SUPERIOR TO WESTWARD TRAINS OF THE SAME CLASS.

WISCONSIN DIVISION

WESTWARD	Rule 6(A) Signs	Length of Siding in Feet	Station Numbers	Line Segment	Mile Post Location	Distance From Hinckley	2nd Subdivn MAIN LINE STATIONS Office Calls		EASTWARD
							214		
								ABJY	
		6,938	51063		62.6	13.1		13.1 PINE CITY	
	Y	6,848	51053		52.7	22.9	RC	9.8 RUSH CITY	
		7,254	51041		40.7	34.9		12.0 NORTH BRANCH	
		7,634	51030		28.6	47.0		12.1 WYOMING	
			51026		24.4	51.2		4.2 FOREST LAKE	
			51017		16.1	59.6		8.4 HUGO	
	A		51013		11.8	63.8		4.2 BALD EAGLE	
	JY	5,723	51012		10.7	64.9		1.1 WHITE BEAR LAKE	

BN Radio Channel No. 1 in service on these Subdivisions.

WISCONSIN DIVISION

WISCONSIN DIVISION

3rd Subdivn  
MAIN LINE

4th Subdivn  
MAIN LINE

STATIONS  
Office Calls

STATIONS  
Office Calls

WESTWARD	Rule 6(A) Signs	Length of Siding in Feet	Station Numbers	Line Segment	Mile Post Location	Distance From Brainerd			EASTWARD
	BJK RTY		52212		0.6	0.0			
		2,417	52542	240	10.5	10.4	B	BRAINERD 10.4	
		2,673	52549		17.5	17.4		MERRIFIELD 7.0	
		2,736	52555		23.5	23.4		NISSWA 6.0	
			52558		26.7	26.6		PEQUOT LAKES 3.2	
		2,703	52564		32.7	32.6		JENKINS 6.0	
			52574		41.9	41.9		PINE RIVER 9.3	
			52582		49.8	49.7		BACKUS 7.8	
			52594		63.0	62.9		HACKENSACK 13.2	
		3,159	52606		75.0	74.9		WALKER 12.0	
			52612		81.4	81.2		LAPORTE 6.3	
	ABJK RTY		05178		94.5	94.7		GUTHRIE 13.5	
		2,389	52630		98.6	98.8		BM BEMIDJI 4.1	
			52642		110.5	110.8		LAVINIA 12.0	
		3,326	52645		113.5	113.7		TENSTRIKE 2.9	
		2,215	52650		118.5	118.7		HINES 5.0	
	T	2,306	52656	125.0	125.2		CK BLACKDUCK 6.5		
			52666	134.6	134.7		FUNKLEY 9.5		
			52671	139.7	139.8		N NORTHOME 5.1		
		2,107	52676	144.4	144.6		MIZPAH 4.8		
			52680	148.7	148.9		GEMMELL 4.3		
		2,343	52688	156.7	156.9		RIDGE 8.0		
			52697	165.8	166.0		MARGIE 9.1		
		2,178	52698	166.8	167.0		BIG FALLS 1.0		
			52707	175.8	176.0		GRAND FALLS 9.0		
		2,252	52715	184.1	184.3		WISNER 8.3		
		3,831	52724	193.4	193.7		LITTLE FORK 9.4		
	BK RTY		52731	200.3	200.6		NAKODA 6.9		
							FN INTERNATIONAL FALLS		

WESTWARD	Rule 6(A) Signs	Length of Siding in Feet	Station Numbers	Line Segment	Mile Post Location	Distance From Carlton			EASTWARD
	IJY	6,729	05033	27	28.0	0.0	UN	CARLTON 16.1	
			52138		44.0	16.1		CORONA 5.5	
			52143		49.5	21.6		CROMWELL 3.8	
		6,604	52147		53.8	25.4		WOODBURY 17.6	
	I	5,994	52165		71.0	43.0	MG	MCGREGOR 8.7	
			52173		79.6	51.7		KIMBERLY 11.9	
	Y	5,698	52185		91.5	63.6		AITKIN 10.3	
	JY		52195		101.9	73.9	DO	DEERWOOD 9.6	
		6,474	52205		111.5	83.5		LOERCH 7.2	
	BJKTY	5,840	52212		118.7	90.7	B	BRAINERD 7.2	
	Y		52217		122.9	94.9		BAXTER 9.2	ABS
		6,310	52226		132.1	104.1		PILLAGER 8.7	
		6,404	52235		140.8	112.8		MOTLEY 7.3	
	BJK RTYX		00567		147.8	120.1	SO	STAPLES	

BN Radio Channel No. 1 in service on these Subdivisions.

## WISCONSIN DIVISION

WESTWARD	Rule (A) Signs	Length of Siding in Feet	Station Numbers	FIRST CLASS	Line Segment	Mile Post Location	Distance From Duluth	5th Subdivn MAIN LINE		FIRST CLASS	EASTWARD
				761				STATIONS		760	
				NRPC 10 Daily				Office Calls		NRPC 9 Daily	
	BJK RTY		05001	6:00PM	214	152.1 150.1	0.0		DULUTH		As 11:35AM
	JY			6:01		1.6	1.0	DT	1.0 GARFIELD AVE.		11:12
	IY			6:03		2.7	2.4		1.4 BRIDGE SWITCH		11:10
	IY					3.4	3.3		0.9 ELEVATOR STATION		
	JY			6:08			4.0		0.7 C & NW CONN		11:01
	BKRY		05004	s 6:15		4.6	4.2	0.2 SUPERIOR	WS To Central Ave. 4.2 miles		s 11:00
<b>BETWEEN SUPERIOR AND CENTRAL AVE. NRPC TRAINS OPERATE OVER LST&amp;T TRACKAGE BETWEEN WINTER ST. AND 16TH AVE. AND BE GOVERNED BY LST&amp;T RR RULES, TIMETABLE, AND SPECIAL INSTRUCTIONS.</b>											
	Y								28TH STREET YARD		
	IJ XY		05008	6:23	27	9.0 9.0	8.4	DT	1.7 CENTRAL AVE.		10:30
	IJ RXY		05010	6:25	28	10.3	10.4		SU	2.0 SAUNDERS	ABS
	IJTX		05013	A 6:29PM		13.3 13.2	13.5	2MT	3.1 BOYLSTON	CTC	10:25AM
			05019			19.1	19.3			5.8 DEWEY	
	X		05023			22.7	23.2	DT	3.9 STATE LINE		
	IJX		05033			35.2	33.1		UN	9.9 CARLTON	ABS
	XY		05039			41.1	39.1	KN	6.0 CLOQUET		
	JX	6,619	05055			57.7	55.6			18.5 BROOKSTON	
		9,345	05063			65.6	63.4	DT	7.8 PAUPORES		
		9,785	05073			76.6	73.4			10.0 FLOODWOOD	
		9,216	05079			82.2	79.5	DT	5.6 ISLAND	CTC	
		9,893	05090			92.1	89.9			9.9 SWAN RIVER	
		9,917	05099			101.0	98.9	DT	9.0 PHILBIN		
	JTY	7,036	05106			108.4	106.4			7.5 GUNN	
	BRY		05109			111.6	109.4	DT	3.0 GRAND RAPIDS	ABS	
		6,225	05115			117.0	114.9			5.5 COHASSET	
	Y	6,950	05124			125.7	123.7	DT	8.8 DEER RIVER		
		3,705	05131			132.8	130.8			7.1 BALL CLUB	
		3,662	05144			145.8	143.7	DT	12.9 BENA		
		6,228	05151			152.9	151.3			7.6 SCHLEY	
	J		05153			155.4	153.3	DT	2.0 SOC. JCT.		
	BKRTY		05163			165.2	162.8			9.5 CASS LAKE	CTC

**EXCEPT ON DOUBLE TRACK AND IN CTC TERRITORY, WHEN IN SERVICE,  
EASTWARD TRAINS ARE SUPERIOR TO WESTWARD TRAINS OF THE SAME CLASS.**

BN Radio Channel No. 1 in service on this subdivision for road crews.

BN Radio Channel No. 2 in service for yard crews Duluth and Superior.

BN Radio Channel No. 3 in service for yard crews Allouez.



WISCONSIN DIVISION

WESTWARD	Rule 6(A) Signs	Length of Siding in Feet	Station Numbers	Line Segment	Mile Post Location	Distance From Brook Park	6th Subdivn MAIN LINE		EASTWARD
							STATIONS		
							Office Calls		
	JY	8553	06057	219	58.3	0.0	BROOK PARK		
			07438		47.0	11.7	MORA		
			07431		39.9	18.8	OGILVIE		
			07424		33.0	25.7	BOCK		
	4671	07418			27.9	30.9	MILACA		
		07415			24.6	34.2	FORESTON		
		07409			18.8	40.0	OAKS		
		07404			13.8	45.0	FOLEY		
		07400			9.5	49.3	PARENT		
	IJRXY		00501		0.0	60.0	ST. CLOUD		EA

BN Radio Channel No. 2 in service for St. Cloud yard area.

WISCONSIN DIVISION

WESTWARD	Rule 6(A) Signs	Length of Siding in Feet	Station Numbers	Line Segment	Mile Post Location	Distance From Ashland	7th Subdivn MAIN LINE		EASTWARD
							STATIONS		
							Office Calls		
	TY		51900	233	0.0	0.0	AJ	ASHLAND	
		2,929	51911		10.7	10.2		MOQUAH	
			51924		24.3	23.8		TOPSIDE	
		1,264	51929		28.4	28.4	RV	IRON RIVER	
		1,370	51937		36.8	36.4		BRULE	
		2,050	51942		41.9	41.5		BLUEBERRY	
			51944		44.5	44.0		MAPLE	
		920	51949		48.5	48.1		POPLAR	Rule S-225
			51951		50.7	50.2		WENTWORTH	
	AY		51962		62.2	61.7		ALLOUEZ	
	TY		51963	63.7	63.2		EAST END		
	Y			63.9	63.4		NEWTON AVENUE		
	Y		51965	65.3	64.9		HILL AVE.		
	IY		51966	66.0	66.3		SOO LINE CROSSING		
	IJR XY		05008	67.9	67.4		CENTRAL AVE.	SU	

BN Radio Channel No. 1 in service on these Subdivisions.

WISCONSIN DIVISION

WESTWARD	Rule 6(A) Signs	Station Numbers	Line Segment	Mile Post Location	Distance From Garfield Ave.	8th Subdivn MAIN LINE		EASTWARD	
						STATIONS			
						Office Calls			
	JY	05001	214	150.1	0.0	GARFIELD AVE.			
	JY	52103		149.3	0.8	WEST D.M. & I.R. JCT.			
	AY	52103		148.5	1.6	SOO LINE CROSSING			
	IJY	52104		147.6	2.5	D. W. & P. JCT.			
	BY	52105		147.0	3.1	WEST DULUTH		ABS	
	JTUY	52106		145.2	3.9	WEST DULUTH JCT.			
				0.0		To Zenith Furnace 0.4			
	Y			235	0.2	4.7	72nd AVE. WEST		
	JY	51978		1.6	6.1	RIVERSIDE JCT.			
	UY	51976		0.0	4.3	ZENITH FURNACE			
	JY	51975	234	1.3	5.2	BERWIND JCT.			
	IY			2.0	5.9	GRASSY POINT DRAW			
	JUY	05004		3.5	7.4	LST&T JCT.			

TRAINS AND ENGINES USING LST&T RAILWAY WEST OF LST&T RY. JCT. WILL BE GOVERNED BY LST&T RY. TIME TABLE AND SPECIAL INSTRUCTIONS.

Trains and engines using D. T. Ry. between 72nd Ave. W. and Riverside Jct. will be governed by Operating Rule 93.

BN Radio Channel No. 2 in service for Duluth yard area.

WISCONSIN DIVISION

WESTWARD	Rule 6(A) Signs	Length of Siding in Feet	Station Numbers	Line Segment	Mile Post Location	Distance From Brookston	9th Subdivn MAIN LINE		EASTWARD
							STATIONS		
							Office Calls		
	J	6,619	05055	236	58.0	0.0	BROOKSTON		
		7,886	52311		69.2	11.4	BADEN		
		7,664	52325		82.7	25.0	FERMOY		
		7,616	52338		97.4	39.9	ONEGA		
	JY		52345		107.5	50.1	K. D. JCT.		CTC
	BJK RT		52401		107.5	50.3	KELLY LAKE		
		5,583	52354		0.0	50.3	KEEWATIN		
			52362		3.8	54.3	NASHWAUK		
	J		52373		9.4	59.9	CALUMET		ABS
	JT		52376		16.0	66.5	TACONITE JCT.		
	T		52382	21.4	71.9	CANISTEO			
	JT	7,036	05106	25.8	76.5	GUNN			
				31.3	81.7				

## WISCONSIN DIVISION

WEST WARD	Rule 6(A) Signs	Length of Siding in Feet	Station Numbers	Line Segment	Mile Post Location	Distance From Dormer Jct.	10th Subdivn MAIN LINE		EAST WARD
							STATIONS		
							Office Calls		
	TY		52440	239	111.1		VIRGINIA 0.7		
	JY				110.4		DM&IR SLIVER BRANCH JCT.		
<b>BETWEEN DM&amp;IR SLIVER BRANCH JCT. AND EMMERT D.M.&amp;I.R. RR TIMETABLE AND SPECIAL INSTRUCTIONS GOVERN.</b>									
	JY		52432	239	107.9	0.0	DORMER JCT. 2.3		
	JY		52427		109.1	2.3	SHERWOOD JCT. 0.2		CTC
	Y	4.128	52426	109.4	2.5	BUHL 0.9			
	Y			110.4	3.4	FRAZER YARD 3.0			
	JY		52418	113.4	6.4	ST. CLAIR JCT. 0.4			
	JY		52416	238	113.7	6.8	WILPEN JCT. 2.1		
	AY		52412		115.8	8.9	EMMERT 3.0		ABS
	XY		52408	118.9	11.9	HIBBING 3.2			
	JXY			122.1	15.1	DT	HIB TAC JCT. 0.5		
	BJK RTY		52401	122.6	15.6		KELLY LAKE		

## WISCONSIN DIVISION

WEST WARD	Rule 6(A) Signs	Station Numbers	Line Segment	Mile Post Location	Distance From Warroad	11th Subdivn BRANCH LINE		EAST WARD
						STATIONS		
						Office Calls		
	BR	55294	244	104.5	0.0	WARROAD 21.4		
		55281		82.9	21.4	ROSEAU 13.0		
		55271	70.0	34.4	BADGER 9.5			
		55253	60.5	43.9	GREENBUSH 18.6			
	U	55234	41.8	62.5	MIDDLE RIVER 19.2			
	T	55230	22.6	81.7	SOO LINE CROSSING 3.1			
		55223	19.6	84.8	VR	THIEF RIVER FALLS 7.2		
		55213	12.3	92.0		ST. HILAIRE 10.3		
			2.0	102.3	RED LAKE FALLS 2.0			
			0.0	104.3	G N JCT.			
	JR	05251	243	87.8	11.0	TILDEN JCT.		
				56.8	115.3			

## WISCONSIN DIVISION

WEST WARD	Rule 6(A) Signs	Length of Siding in Feet	Station Numbers	Line Segment	Mile Post Location	Distance From Fisher Line Jct.	12th Subdivn MAIN LINE		EAST WARD
							STATIONS		
							Office Calls		
	JY			32	83.4	0.0	FISHER LINE JCT. 0.5		
	JTY		09268		0.5	0.5	NOYES JCT. 12.2		
			09301	12.7	12.7	EUCLID 8.2			
			09309	20.9	20.9	ANGUS 3.4			
	A		09317	29.3	29.3	W	WARREN 9.8		
			09327	39.1	39.1	ARGYLE 8.4			
			09335	47.5	47.5	NE	STEPHEN 8.6		
			09344	56.1	56.1	DONALDSON 4.8			
			09349	60.9	60.9	KENNEDY 9.2			
		2.980	09358	70.1	70.1	KA	HALLOCK 12.2		
			09370	82.3	82.3	HUMBOLDT 8.2			
	BJKRY		09378	90.5	90.5	NY	NOYES		

## WISCONSIN DIVISION

WEST WARD	Rule 6(A) Signs	Station Numbers	Line Segment	Mile Post Location	Distance From Allouez	13th Subdivn BRANCH LINE		EAST WARD	
						STATIONS			
						Office Calls			
	BIJR TXY	52004	29	6.0	0.0	DT	ALLOUEZ 1.9		
	Y			7.9	1.9		KOPPERS SPUR 1.0		ABS
			8.7	2.9	BRIDGE (1.3)				
	IJRX	05010	10.3	4.2	B	SAUNDERS 1.3			

BN Radio Channel No. 1 in service on these Subdivisions except Allouez Yard Engines use Channel No. 3.

WISCONSIN DIVISION

WESTWARD	Rule 6(A) Signs	Length of Siding in Feet	Station Numbers	Line Segment	Mile Post Location	Distance From Manitoba Jct.	14th Subdivn MAIN LINE		EASTWARD
							STATIONS		
							Office Calls		
	JRTY		00650	246	0.8	0.0	MANITOBA JCT.		
		1,128	55005		6.0	5.0	HITTERDAL		
		2,335	55012		12.9	11.9	ULEN		
			55019		19.9	18.9	SYRE		
		3,060	55025		25.6	24.6	TWIN VALLEY		
			55032		33.8	32.4	GARY		
		2,727	55044		45.4	44.0	FERTILE		
			55052		53.4	52.0	MELVIN		
		1,936	55060		61.3	59.9	HAROLD		
	JY		05265		65.9	67.4	REDLAND JCT.		

WISCONSIN DIVISION

WESTWARD	Rule 6(A) Signs	Length of Siding in Feet	Station Numbers	Line Segment	Mile Post Location	Distance From Glyndon	15th Subdivn MAIN LINE		EASTWARD
							STATIONS		
							Office Calls		
	JY	3,079	00668	32	18.4	0.0	GLYNDON		
			09229		25.1	6.9	AVERILL		
			09237		32.9	14.7	FELTON		
			09244		40.0	21.8	BORUP		
			09252		48.2	30.0	ADA		
			09270		65.1	47.0	BELTRAMI		
	JY		09285		80.3	62.3	M. N. JCT.		
	JY				80.9	63.0	CROOKSTON JCT.		

WISCONSIN DIVISION

WESTWARD	Rule 6(A) Signs	Station Numbers	Line Segment	Mile Post Location	Distance From Moorhead	16th Subdivn BRANCH LINE		EASTWARD
						STATIONS		
						Office Calls		
	JY	00676	247	0.0	0.0	MOORHEAD		
		56008		8.0	8.6	KRAIGES		
		56015		14.8	15.4	GEORGETOWN		
		56022		21.6	22.0	PERLEY		
		56028		27.4	28.0	HENDRUM		
		56034		33.5	34.0	HALSTAD		
		56041		41.0	41.6	SHELLY		
		56046		45.8	46.4	NIELSVILLE		
		56052		50.8	52.0	CLIMAX		
		56057		56.8	57.9	ELDRID		
	JY	09285		65.5	66.5	M. N. JCT.		

WISCONSIN DIVISION

WESTWARD	Rule 6(A) Signs	Length of Siding in Feet	Station Numbers	Line Segment	Mile Post Location	Distance From Calspur Jct.	17th Subdivn BRANCH LINE		EASTWARD
							STATIONS		
							Office Calls		
	JUY		55502	249	98.5	0.0	CALSPUR JCT.		
		5,885	55416		112.4	13.9	MEKINOCK		
			55422		117.8	19.3	HONEYFORD		
		3,967	55425		121.3	22.8	GILBY		
			55430		125.6	27.1	JOHNSTOWN		
	UY	3,946	55434		130.3	31.8	FOREST RIVER		
		4,978	55440		136.1	37.6	VOSS		
	BJR TUY	2,513	55539		145.0	46.5	GRAFTON		
	Y	3,256	55464		160.5	62.0	DRAYTON		
		2,249	55483		178.8	80.3	JOLIETTE		

WISCONSIN DIVISION

WESTWARD	Rule 6(A) Signs	Length of Siding in Feet	Station Numbers	Line Segment	Mile Post Location	Distance From PA Tower	18th Subdivn BRANCH LINE		EASTWARD
							STATIONS		
							Office Calls		
	IJY		05299	250	0.0	0.0	PA TOWER		
	JUY		55502		1.4	1.4	CALSPUR JCT.		
			55512		12.5	12.0	MANVEL		
	U		55524		24.5	24.1	ARDOCH		
			55530		30.6	30.2	MINTO		
	BJR TUY	4,481	55539		39.4	39.1	GRAFTON		
			55546		45.9	45.6	AUBURN		
	Y		55553		53.5	53.2	ST. THOMAS		
			55559		59.6	59.3	GLASSTON		
			55566		66.5	66.2	HAMILTON		
			55571	71.6	71.4	BATHGATE			
	Y		55579	79.9	79.7	NECHE			

BN Radio Channel No. 1 in service on these Subdivisions.

## WISCONSIN DIVISION

WESTWARD	Rule 6(A) Signs	Length of Siding in Feet	Station Numbers	Line Segment	Mile Post Location	Distance From Grafton	19th Subdivn BRANCH LINE		EASTWARD
							STATIONS		
							Office Calls		
BJR TUY			55539	251	0.0	0.0	FN	GRAFTON	
			55606		5.7	6.5	NA	NASH	
Y	3,408	55613			12.9	13.7	HO	HOOPLE	
		55618			17.5	18.3	CT	CRYSTAL	
		55624			23.9	24.6		HENSEL	
		55631			31.4	32.2	CV	CAVALIER	
RT		55648		48.5	48.7	WA	WALHALLA		

## WISCONSIN DIVISION

WESTWARD	Rule 6(A) Signs	Length of Siding in Feet	Station Numbers	Line Segment	Mile Post Location	Distance From Hannah Jct.	21st Subdivn BRANCH LINE		EASTWARD
							STATIONS		
							Office Calls		
J			05325	252	0.0	0.0		HANNAH JCT.	
			55706		5.8	6.0		McCANN	
			55717		16.6	16.8		INKSTER	
			55728		28.0	28.3		PISEK	
T	2,445	55734			34.2	34.5	K	PARK RIVER	
		55744			43.5	43.8		EDINBURG	
		55756		56.1	56.4		MILTON		
		55762		61.9	62.1		OSNABROCK		
R	1,992	55774		73.6	73.8		LANGDON		
		55788		88.0	88.2		WALES		
T		55795		95.0	95.2		HANNAH		

## WISCONSIN DIVISION

WESTWARD	Rule 6(A) Signs	Length of Siding in Feet	Station Numbers	Line Segment	Mile Post Location	Distance From Coss Lake	20th Subdivn MAIN LINE		EASTWARD
							STATIONS		
							Office Calls		
				31	105.2	0.0	CS	CASS LAKE	
					95.6	9.6		ROSSBY	
					90.3	15.3	BM	BEMIDJI	
	8,129	05184			84.1	21.4		WILTON	
	3,664	05196			72.0	33.7		SHEVLIN	
		05203			65.1	40.4		BAGLEY	
	8,239	05211			57.7	47.7		EBRO	
	3,688	05224			44.7	60.7		FOSSTON	
	9,033	05231			37.2	68.3	FO	McINTOSH	
A	3,823	05237			31.2	74.4		ERSKINE	
	3,687	05244			24.5	81.1	RS	MENTOR	
JRY		05251			17.7	88.0		TILDEN JCT.	
	9,038	05255			12.9	92.5		BENOIT	
JY		05265			2.9	102.7		REDLAND JCT.	
J					0.5	105.6		CROOKSTON JCT.	
BJK RTY		05270		0.0	106.9		CROOKSTON		
JY		05271		83.4	108.0		FISHER LINE JCT.		
JY				83.9	108.5		NORTH CROOKSTON JCT.		
	7,710	05280		93.1	117.7		FISHER		
BKRY		05295		107.5	132.1		GRAND FORKS		
LRTY		05299		111.9	134.6		PA TOWER		
IJT			4:46AM	2.2	135.8		D. L. SWITCH	A 11:33PM	
	7,581	05310	5:01	12.3	147.7		EMERADO	11:22	
		05316		18.3	153.8		ARVILLA		
JKRTY	9,288	05323	5:11	24.3	159.8		LARIMORE	11:11	
JY		05325	A 5:13AM	26.7	162.1		HANNAH JCT.	11:09PM	

EASTWARD TRAINS ARE SUPERIOR TO WESTWARD TRAINS OF THE SAME CLASS.  
BN Radio Channel No. 1 in service on these Subdivisions.

INDUSTRIAL TRACKS AND OTHER TRACKS NOT SHOWN AS STATIONS IN TIME TABLE

Name	Location	Capacity Cars	Switch Opens	Name	Location	Capacity Cars	Switch Opens
<b>First Subdivision</b>				<b>Seventh Subdivision</b>			
06002	North Central Public Service Spur	6	West	51902	Midland Services, Inc.	7	West
06012	Cedar	8	West	51917	Ino	12	West
06024	Husky Spur	2	West	51957	Cutter	5	East
06024	Isanti	54	Both	<b>Ninth Subdivision</b>			
06032	Rural Coop. Power Ass'n. Spur	5	East	52306	Arlberg	15	East
06034	Grandy	3	East	52331	Casco	16	East
06094	Kerrick	8	East	52338	Old Onega Spur	6	East
<b>Second Subdivision</b>				52350	Keewatin Saw Mill Spur	10	East
51025	Winnick Spur	2	West	52350	Mid-Range Builders Supply	7	West
51033	Stacy Spur	15	East	52377	Bovey	15	East
51046	Harris Spur	21	East	52380	Oil Spur	35	West
51058	Rock Creek Spur	21	East	<b>Tenth Subdivision</b>			
51064	Gorham Spur	5	West	52422	Elbern Siding	36	Both
51069	Beroun Spur	24	West		16th Avenue Ramp	4	East
<b>Third Subdivision</b>					Oil Track	17	Both
52565	Bemidji Bottle Gas Co. Spur	5	West		Douglas Shop Spur	9	West
<b>Fourth Subdivision</b>				<b>Eleventh Subdivision</b>			
51135	Wrenshall	130	Both	55314	Ralston Purina Spur	6	East
52132	Sawyer	5	East	55313	Marvin Elev. Spur	33	West
52150	Wright	21	West	55303	Salol	14	Both
52156	Tamarack	3	East	55293	Farm Service Equip. Spur	6	East
52179	Rosburg	9	West	55290	Roseau Pit	36	East
52804	Ironton	9	Both	55288	Fox	16	Both
52218	Klein Spur	14	East	55261	Strathcona	10	Both
52240	Northern Mfg. Spur	9	West		10.2 miles west of Greenbush	23	West
<b>Fifth Subdivision</b>				55227	Northwest Pellet Ass'n Spur	10	West
05029	Alford	10	East		Falls	19	West
	Lindsay Pit	70	East	FUGTA Elev. Spur	1.0 mile west of Red Lake Falls	19	West
	Brookston Gravel Pit	80	Both	<b>Twelfth Subdivision</b>			
05068	Mirbat	7	East	09289	Agricultural Exp. Spur	33	East
05086	Wawina	21	East	09314	Roan	12	East
05113	Seyton	52	Both	09316	Fertilizer Spur	7	East
	Rapids	9	East	09319	Earl Swanson Spur	17	West
05114	Cohasset Mill & Lumber Co.	9	East	09321	Luna	10	East
05116	Minn. Power and Light Spur	121	East		Argyle Potato Services Spur	17	West
05123	Chippewa Wood Processing Spur	16	West		Industrial Site Spur	15	East
05156	Webster Lumber co.	16	East	09376	St. Vincent	13	Both
<b>Sixth Subdivision</b>				09350	S. P. Lipoma Potato Whse. Spur	52	East
00501	Volkmoth Printers Spur	11	East		0.7 mile west of Kennedy	9	West
	Rural Co-op Power Ass'n Spur	3	West		0.8 miles east of Hallock	7	East
07439	Kanabec Hdwe. Co. Spur	4	West	09357	George Weleski Spur	7	East
				09364	Hill Siding	16	Both
				<b>Fourteenth Subdivision</b>			
				55054	Spring Pit	82	West
					J. R. Dale Farm Supply Spur	7	East

## WISCONSIN DIVISION

## INDUSTRIAL TRACKS AND OTHER TRACKS NOT SHOWN AS STATION IN TIME TABLE

Name	Location	Capacity Cars	Switch Opens	Name	Location	Capacity Cars	Switch Opens
<b>Fifteenth Subdivision</b>							
09251	American Oil Co. Spur	13	West	55630	Red River Fertilizer & Valley Bean Ass'n Spur	14	West
09257	Hadler	31	Both	55636	Backoo	34	Both
09262	Lockhart	12	East	55645	Ted Eggan Potato Whse.	8	West
09275	Greenview	23	Both	55646	Johnson Potato Co. Spur	13	East
<b>Sixteenth Subdivision</b>							
56002	Bingham	626	Both	<b>Twentieth Subdivision</b>			
56064	Wilds	730	East	05167	Farris	15	Both
<b>Seventeenth Subdivision</b>				05169	Potlatch Spur	15	East
				05179	Airport Spur	18	West
55125	Key West	17	Both	05188	Northwood Spur	18	East
	Pillsbury Co. Spur	7	East	05190	Solway	30	Both
	Kelly	26	Both	05216	Lengby	14	East
55456	Cashel	33	Both	05243	Solar Gas	66	Both
	Potato Whse. Spur	30	East	05259	Benoit Pit	157	West
	Drayton Potato Packer Spur	12	East	05282	Burwell	17	West
	American Crystal Plant	Yard	Both	05288	Mallory	18	East
55469	Pittsburg	35	Both	05301	Powell	17	Both
55473	Bowesmont	27	Both	05311	Emerado Air Base Spur	125	East
<b>Eighteenth Subdivision</b>				<b>Twenty-First Subdivision</b>			
55535	Herriott	39	Both	Forest River Bean Plant Spur			
55554	Tobiason Gillishammer	10	East	55713	Orr	9	West
55528	Miller-Rudnik	5	East	55723	Conway	28	Both
55527	Process Potatoes Inc.	9	East	Rossford Johnson Spur			
<b>Nineteenth Subdivision</b>				55740	Kerry	20	Both
55610	Hoople Industries	57	East	55741	Kerry Pit	20	Both
55611	Folsom-Fedje Spur	11	East	55750	Union	116	East
55614	Hoople Potato Products Inc. Spur	16	East	55768	Easby	28	West
	Murray Bean Co.	3	East	55781	Dresden	30	Both
						34	Both

## WISCONSIN DIVISION

## MINE SPURS

Name	Location	Switch Opens
52403	Hibbing Taconite Mahoning	West
52404	Group Lines and So. Agnew	West
52430	Wanless	East
	Atkins, Wade	East
52352	National Taconite	East
52352	National Taconite	West
52356	Mesabi Chief Washer, Mississippi	West
52365	Butler Taconite	East
	Butler Taconite, Patrick	West
52370	Hill Annex Creta	East
52371	Hill Annex Washer	East
52374	Hill Trumbull Washer	East
52381	Canisteo Mine	Both
52385	Greenway	West
<b>Fourth Subdivision (Mine Spurs—Cuyuna Range)</b>		<b>Distance From Deerwood</b>
52804	Ironton	3.8
52808	Cuyuna	7.5
52814	Manganese	14.0
52853	Riverton	7.6
52854	Trommald	7.9

**WISCONSIN DIVISION  
LINE SEGMENT NUMBERS**

**DULUTH-SUPERIOR TERMINAL LINE SEGMENTS**

Line Segment	Duluth	Limits
500	5th Avenue Yard	East 5th Avenue—5th Avenue West
501	Bridge Yard	5th Avenue West—Garfield Avenue
502	Commerce Tracks	5th Avenue West—15th Avenue West
503	Birch Street Yard	Garfield Avenue—Minnesota Draw
504	Rice's Point Yard	Garfield Avenue—Minnesota Draw
505	DT Tracks	20th Avenue West—Minnesota Steel Connection
506	Boston Yard	Elliott Packing Track—47th Avenue West
507	Berwind Yard	47th Avenue West—Main Street
508	Mikes Yard	Main Street—72nd Avenue West
<b>Superior</b>		
509	Belknap Yard	Winter Street—28th Street
510	17th Street Yard	Elevator Station—28th Street
511	28th Street Yard	28th Street—Central Avenue
512	Central Avenue Yard	Central Avenue—28th Street
513	Saunders Yard	Saunders Tower—Yard Board
514	East End Yard	15th Avenue East—31st Avenue East
515	BN Interchange	40th Avenue East—44th Avenue East
516	Allouez Ore Yard	Bardon Avenue—CNW Crossing —Docks #2 and #4
517	Allouez Tac Yard	Bardon Avenue—CNW Crossing Dock #1
518	Hill Avenue Yard	31st Avenue East—Central Avenue

**OTHER YARD LINE SEGMENTS**

Line Segment	Yard
519	Cloquet
520	Bemidji
521	Grand Forks
522	Crookston
523	Brainerd Shop
524	Brainerd Tie Plant
525	Brainerd Yard
526	Grand Forks WFE

**BALLAST PITS**

Line Segment	Ballast Pit
570	Backus
571	Brookston
572	Benoit
573	Clarissa
574	Crosby (Ore Tailings)
575	Kerry
576	Linsey
577	Roseau

**OTHER ROAD LINE SEGMENTS**

Line Segment	Limits	Mileposts
27	Wrenshall—Carlton	23.9 to 28.0
28	Central Avenue—Elevator Station	9.0 to 3.1
232	North Crookston Jct.—Noyes Line	82.4 to 83.5
248	Carthage Jct.—Keywest	99.8 to 93.5
249	Carthage Jct.—Calspur Jct.	90.2 to 98.5
253	Cuyana Range	0.0 to 9.9
254	Tioga Mine	0.0 to 3.3
256	Lind-Greenway Mine	0.0 to 3.4
257	Hibbing Taconite Line	0.0 to 6.6
258	Canisteo Mine	0.0 to 2.8
259	Aromack Mine	0.0 to 2.5
260	National Taconite	0.0 to 4.2
261	Butler Taconite Spur	0.0 to 2.5
262	Chisholm Line	0.0 to 2.3

## DAKOTA DIVISION

WESTWARD	Rule 6(A) Signs	Length of Siding in Feet	Station Numbers	FIRST CLASS			Line Segment	Mile Post Location	Distance From Dilworth	1st Subdivn MAIN LINE STATIONS			FIRST CLASS	EASTWARD			
				7						Office Calls					8		
				NRPC Daily											NRPC Daily		
	BKR TXY		00673	3:10AM				3.2	0.0	DH	DILWORTH		A 1:08AM				
	IJXY		00875	A 3:13AM				5.5	2.4		MOORHEAD JCT.		1:05AM				
	AJTYX		00879					8.5	5.4	DT	FARGO	Rule 251-254					
	IJXY		00883					12.9	9.7		WEST FARGO						
Y	W4,399	00686						15.9	12.7		FIFE	ABS					
		00690						20.1	17.0		MAPLETON						
	JTYX		00698					28.4	24.5	CT	CASSELTON	CTC					
J		10046						31.0	27.8		SURREY LINE JCT.						
Y		03279					26	43.8	40.6	DT	BUFFALO	R251-254					
		03285							49.7		46.5		TOWER CITY				
		6,478	03288						52.4	49.2	KOLDOK	ABS					
			03290						55.3	52.0	ORISKA						
		6,794	03296						60.4	57.1	PEAK						
			03301						65.5	62.3	VALLEY CITY						
Y	6,371	03306							70.0	66.7	BEREA						
JTY	7,940	03312							76.1	72.8	SANBORN						
		6,470	03317						81.4	78.1	ECKELSON						
Y	6,302	03325							89.1	85.8	SPIRITWOOD						
			03331					95.2	91.9	BLOOM							
								99.3		DT							
								92.2									
	BJK RTXY		03336					93.7	97.4		JY	JAMESTOWN					
Y		03342						99.9	103.6			ELDRIDGE					
		7,243	03352					109.0	112.8			WINDSOR					
		3,635	03356					112.8	116.6			CLEVELAND					
		7,336	03364					121.5	125.3		MD	MEDINA					
		11,585	03377					134.5	138.2			LADOGA					
			03380				38	137.6	141.3			TAPPEN					
		6,235	03386						143.2		146.9		DAWSON				
		7,396	03394						151.0	154.7		STEELE					
		6,255	03404						161.9	165.4		DRISCOLL					
		6,197	03412						169.6	173.2		STERLING					
JT			03419						176.2	179.8	MZ	MCKENZIE					
		6,313	03424						181.6	185.3			BURLEIGH				
		6,571	03432						189.5	193.1		PIERCE					
Y	7,932	03437							194.5	198.1		BISMARCK					

EXCEPT ON DOUBLE TRACK EASTWARD TRAINS ARE SUPERIOR TO WESTWARD TRAINS OF THE SAME CLASS.

BN Radio Channel No. 1 in service on this Subdivision.



DAKOTA DIVISION

WESTWARD	Rule 6(A) Signs	Length of Siding in Feet	Station Numbers	FIRST CLASS			Line Segment	Mile Post Location	Distance From Breckenridge	2nd Subdivn MAIN LINE STATIONS			Office Calls	FIRST CLASS		EASTWARD
				7						8						
				NRPC Daily						NRPC Daily						
	BKRT		03204			22	215.0	0.0	BR	BRECKENRIDGE						
			03207			23	0.5	1.0		1.0	Wahpeton	CTC				
	JY		03209				1.4	0.0		1.8	Wahpeton Jct.					
			10012				12.3	14.2			Kent	ABS				
		4,638	10021			288	21.3	23.2			Wolverton					
		4,297	10028				28.1	30.0			Comstock					
	IJXY	5,966	00675		3:13AM		42.8	21.4		44.6	Moorhead Jct.		A 1:05AM			
	JY	2,855	00676		3:15	220	22.3	45.5			Moorhead		1:02			
	JY		00677		3:17		23.1	46.3			Fargo Jct.		1:01			
	BIK				3:26		23.4	0.0		46.6	Fargo PSGR Station	Rule 261 284	1:00			
	RY		00678		s 3:30		0.0	46.6	2MT		Fargo Yard Office		s 12:56			
	BJKRTXY		00679	A	3:31AM	34	0.1	46.7					12:48AM			
	IJY						3.9	50.5			JY Jct.	ABS				
	IJY		00683			291	6.6	53.2			West Fargo					

EXCEPT WHERE RULE 261 IS IN EFFECT EASTWARD TRAINS ARE SUPERIOR TO WESTWARD TRAINS OF THE SAME CLASS.

DAKOTA DIVISION

WESTWARD	Rule 6(A) Signs	Length of Siding in Feet	Station Numbers	Line Segment	Mile Post Location	Distance From Wahpeton Jct.	3rd Subdivn MAIN LINE STATIONS			Office Calls	EASTWARD
							STATIONS				
							Office Calls				
	JY		03209		1.4	0.0			Wahpeton Jct.		
		7,162	03213		7.4	6.0			Dwight		
		3,764	03220		14.1	12.6			Galchutt		
		7,452	03227		20.6	19.2			Colfax		
		2,350	03233	23	26.9	25.4			Walcott	ABS	
		7,131	03241		34.7	33.3			Kindred		
	A		03246		39.6	38.3			Davenport		
	J		03251		44.0	42.6			Chaffee Line Jct.		
		7,094	03253		47.4	46.1			Durbin		
	JTY	3,789	00698		55.0	53.8			Casselton	CT	

BN Radio Channel No. 1 in service on these Subdivisions.

DAKOTA DIVISION

WESTWARD	Rule 6(A) Signs	Length of Siding in Feet	Station Numbers	Line Segment	Mile Post Location	Distance From Surrey Line Jct.	4th Subdivn MAIN LINE		EASTWARD
							STATIONS		
							Office Calls		
	J			24	3.3	0.0	SURREY LINE JCT. 7.6		
		9,673	00709		10.5	7.6	ABSARAKA 6.0		
			00715		16.7	13.6	AYR 7.5		
	J	10,321	00724	34	24.3		NOLAN 12.1		
		6,935	00736		40.7	21.1	PILLSBURY 7.4		
		9,206	00744		52.8	33.2	LUVERNE 12.7		
	J	9,639	00757		60.2	40.6	HANNAFORD 13.4		
		9,717	00770		73.0	53.3	SUTTON 7.0		
			00777		86.4	66.7	GLENFIELD 6.6		
		9,693	00784		99.9	80.3	JUANITA 6.4		
			00790		106.3	86.7	GRACE CITY 6.4		
		9,575	00796		112.7	93.1	BRANTFORD 11.6		
	JT	10,498	00808		124.3	104.7	KO	NEW ROCKFORD 12.5	
		9,257	00820		136.8	117.2	BREMEN 6.1		
			00827		142.9	123.3	HAMBERG 6.4		
		9,154	00833		149.5	129.7	HEIMDAL 12.4		
		9,189	00845		161.7	142.1	SELZ 15.3		
		9,796	00861		177.0	157.4	AYLMER 9.8		
		9,374	00870		186.8	167.2	GUTHRIE 12.8		
		9,331	00883		199.6	180.0	KARLSRUHE 12.3		
		9,675	00896		211.9	192.3	SIMCOE 14.1		
	J		05495		226.0	206.4	SURREY		

DAKOTA DIVISION

WESTWARD	Rule 6(A) Signs	Length of Siding in Feet	Station Numbers	Line Segment	Mile Post Location	Distance From Jy Jct.	5th Subdivn MAIN LINE		EASTWARD
							STATIONS		
							Office Calls		
	JY		10049	34	3.9	0.0	JY JCT. 7.5		
		3,559	56111		12.4	8.3	PROSPER 10.4		
	JT	3,346	00707		22.9	18.7	VANCE 6.1		
		3,546	00713		28.9	24.8	MASON 3.0		
	J		00716		31.9	27.8	ERIE JCT. 9.0		
	J		00724		40.7	36.8	NOLAN		

DAKOTA DIVISION

WESTWARD	Rule 6(A) Signs	Station Numbers	Line Segment	Mile Post Location	Distance From Casselton	6th Subdivn MAIN LINE		EASTWARD
						STATIONS		
						Office Calls		
	JTY	00698	23	55.0	0.0	CT	CASSELTON 7.0	
		00705		62.1	7.0		AMENIA 2.1	
	JT	00707		64.2	9.1		VANCE	

BN Radio Channel No. 1 in service on these Subdivisions.

DAKOTA DIVISION

WESTWARD	Rule 6(A) Signs	Length of Siding in Feet	Station Numbers	FIRST CLASS	Line Segment	Mile Post Location	Distance From Minot	7th Subdivn MAIN LINE STATIONS Office Calls				FIRST CLASS	EASTWARD		
				7								8			
				NRPC Daily								NRPC Daily			
	Y		00917	8:35AM	35	0.0	0.0	AD	MINOT	ABS	As 7:45PM				
	IJR					0.5	0.1	DT	SX	SOO TOWER	Rule 251-254				
	A					4.8	4.3			W. L. SWITCH			7:31		
	A					5.2	5.0			GASSMAN SWITCH					
			00930			13.8	13.5	DT		DES LACS					
	J	10,333	00939			22.8	22.3			BERTHOLD					
		9,843	00956			39.4	38.8			BLAISDELL					
			00983			46.6	45.8			PALERMO					
	JT	13,701 10,139	00970	s 9:30		54.3	53.6			STANLEY		CTC	s 6:50		
		8,368	00978			61.5	60.9			ROSS					
		6,987	00990			73.5	72.9			WHITE EARTH					
		5,648	00998			81.8	80.8			TIOGA					
		13,309	01003			87.4	86.3			TEMPLE					
			01009			93.7	92.6			RAY					
		9,111	01015			99.0	97.9			WHELLOCK					
			01020	10:15		104.2	102.9			EPPING					
	BKR TY		01036	As 10:52AM		121.1	120.0	DT	WN	WILLISTON	Rule 251-254		5:45PM		

EXCEPT ON DOUBLE TRACK OR IN CTC TERRITORY, WHEN IN SERVICE, EASTWARD TRAINS ARE SUPERIOR TO WESTWARD TRAINS OF THE SAME CLASS.

DAKOTA DIVISION

WESTWARD	Rule 6(A) Signs	Length of Siding in Feet	Station Numbers	FIRST CLASS	Line Segment	Mile Post Location	Distance From Fargo Yard Office	8th Subdivn MAIN LINE STATIONS Office Calls				FIRST CLASS	EASTWARD
				7								8	
				NRPC Daily								NRPC Daily	
	BJKRTY		10049	3:31AM	220	23.5	0.0		FARGO YARD OFFICE	ABS	A 12:48AM		
	JY			3:35		25.9	2.4		DAKOTA JCT.			12:45	
		6,455	10053	3:39		31.9	7.0		HARWOOD			12:42	
		2,617	10059			37.5	12.6		ARGUSVILLE				
		5,543	10066	3:50		44.4	19.4		GARDNER			12:32	
		6,482	10072	3:55		50.6	25.7		GRANDIN			12:29	
	Y	7,367	10084	4:07		62.3	37.6	HS	HILLSBORO			12:17	
		4,019	10092	4:14		70.1	45.4		CUMMINGS			12:11	
		6,460	10098	4:19		76.1	51.4		BUXTON			12:06	
		3,971	10103	4:23		81.1	56.3		REYNOLDS			12:02AM	
		5,618	10110	4:30		88.2	63.5		THOMPSON		11:56		
	IJT			4:39		98.7	74.1		F.O. SWITCH		11:46		
				s 4:40			74.4		WEST GRAND FORKS		11:45		
	IT			4:45					D. L. SWITCH		s 11:40		
	IJT			A 4:46AM			74.6				11:33PM		

EASTWARD TRAINS ARE SUPERIOR TO WESTWARD TRAINS OF THE SAME CLASS.

BN Radio Channel No. 1 in service on these Subdivisions.

DAKOTA DIVISION

WESTWARD	Rule 6(A) Signs	Length of Siding in Feet	Station Numbers	FIRST CLASS		Line Segment	Mile Post Location	Distance From Hannah Jct.	9th Subdivn MAIN LINE STATIONS Office Calls		FIRST CLASS		EASTWARD
				7					8				
				NRPC Daily					NRPC Daily				
	JY		05325	5:13AM			26.7	0.0	HANNAH JCT. 11.6		A 11:09PM		
		8,940	05336				38.3	11.6	NIAGARA 6.3		10:56		
			05343				44.5	17.9	PETERSBURG 5.8				
		8,883	05348	5:32			50.3	23.7	MICHIGAN 10.4		10:45		
	JRTY	8,908	05359	5:41			60.7	34.1	LAKOTA 8.9		10:36		
			05368				69.6	43.0	DOYON 4.8				
		9,837	05373	5:52			74.5	47.8	CRARY 10.8		10:25		
	BJK			6:05							10:15		
	RTY		05383	s 6:08			85.3	56.6	WS DEVILS LAKE 13.0		s 10:12		
			05396	6:18			98.2	71.6	PENN 6.0		9:50		
	JRTY	6,511	05402				104.2	77.6	CHURCHS FERRY 11.4		ABS 9:31		
		8,214	05414	6:34		33	115.7	89.0	LEEDS 6.3				
	JRTY	4,540	05420				121.9	95.3	YORK 5.5				
			05426				127.8	101.3	KNOX 9.0				
			05432				133.4	106.8	PLEASANT LAKE 5.3				
	JTY	6,286	05441	s 7:10			142.4	115.8	RU RUGBY 6.3		s 9:02		
		3,586	05446				147.6	121.1	TUNBRIDGE 7.4				
		3,631	05452				153.9	127.4	BERWICK 3.5				
	JTY	8,882	05460	7:30			161.3	134.8	TOWNER 12.1		8:38		
		3,661	05468				170.0	143.6	DENBIGH 6.9				
	JTY	3,574	05481	7:50			182.0	155.7	GRANVILLE 7.2		8:18		
		3,621	05487				188.9	162.6	NORWICH 2.3				
	JY		05495	8:05			196.0	169.8	SURREY 1.1		8:07		
	BJKRTY		00911				197.9	172.1	GAVIN YARD 3.9		CTC		
	Y		00913				199.7	173.2	J. D. SWITCH 1.1				
	Y		00917	As 8:20AM			203.2	177.1	AD MINOT 3.9		ABS 8:00PM		

EXCEPT IN CTC TERRITORY, WHEN IN SERVICE, EASTWARD TRAINS ARE SUPERIOR TO WESTWARD TRAINS OF THE SAME CLASS.

DAKOTA DIVISION									
WESTWARD	Rule 6(A) Signs	Length of Siding in Feet	Station Numbers	Line Segment	Mile Post Location	Distance From Vance	10th Subdivn BRANCH LINE STATIONS Office Calls		EASTWARD
							23		
							Rule S-225		
	JT		00707		64.2	0.0	VANCE 5.0		
			56305		69.0	5.0	ARTHUR 6.0		
			56311	23	75.0	11.0	HUNTER 10.7		
			56322		86.0	21.7	BLANCHARD		

DAKOTA DIVISION									
WESTWARD	Rule 6(A) Signs	Station Numbers	Line Segment	Mile Post Location	Distance From Erie Jct.	Rule S-225	11th Subdivn BRANCH LINE STATIONS Office Calls		EASTWARD
							274		
							Rule S-225		
	J	00716		0.0	0.0		ERIE JCT. 1.6		
		56402		1.4	1.6		ERIE 10.7		
		56412	274	12.1	12.3		GALESBURG 5.7		
		56418		17.5	18.0		CLIFFORD		

BN Radio Channel No. 1 in service on these Subdivisions.

DAKOTA DIVISION

12th Subdivn  
BRANCH LINE

STATIONS  
Office Calls

Rule 6(A) Signs	Station Numbers	Line Segment	Mile Post Location	Distance From Fargo
JTYX	00679		0.0	0.0
Y	56611		9.5	10.6
A	03246		18.2	19.4
	56625		24.3	25.4
	56629		28.0	29.1
A	56641		40.4	41.5
	56651		49.5	50.6
	56656		55.2	56.3
	56664		62.8	64.0
	56669		67.7	68.7
	56677		75.6	76.6
JRTY	56683		81.7	82.8
JRY	56688		87.0	88.1
	56698		97.1	98.2
TY	56708		106.8	108.0
	56722		121.0	122.1
	56729		128.2	129.3
	56737		135.4	136.5
T	56747		146.7	147.4

FARGO	10.8
HORACE	8.8
DAVENPORT	6.0
WOODS	3.7
LEONARD	12.4
SHELDON	9.1
BUTZVILLE	5.7
LISBON	7.7
ELLIOTT	4.7
ENGLEVALE	7.9
VERONA	6.2
INDEPENDENCE	5.3
LAMOURE	10.1
BERLIN	9.8
EDGELEY JCT.	14.1
JUD	7.2
ALFRED	7.2
GACKLE	10.9
STREETER	

276

DAKOTA DIVISION

14th Subdivn  
BRANCH LINE

STATIONS  
Office Calls

Rule 6(A) Signs	Station Numbers	Line Segment	Mile Post Location	Distance From Sanborn
JTY	03312		0.0	0.0
U	57310		9.6	10.0
	57318		17.8	18.1
	57324		23.3	23.6
JY	00757		26.4	26.7
	57406		32.5	32.8
	57410		36.5	36.7
	57425		51.0	51.2

SANBORN	10.0
ROGERS	8.1
DAZEY	5.5
WALUM	3.1
HANNAFORD	6.1
SHEPARD	3.9
COOPERTOWN	14.5
BINFORD	

281

Rule S-225

DAKOTA DIVISION

15th Subdivn  
BRANCH LINE

STATIONS  
Office Calls

Rule 6(A) Signs	Station Numbers	Line Segment	Mile Post Location	Distance From Pingree
JRTY	57521		0.4	0.0
	57620		20.5	20.5
	57632		31.9	31.9
	57637		36.7	36.7
	57645		44.7	45.1
	57655		54.6	55.1
	57663		62.9	63.3
	57669		68.6	69.1
	57681		80.7	81.2
	57686		85.9	86.3
T	57693		92.8	93.2

PINGREE	20.5
WOODWORTH	11.4
PETTIBONE	4.8
LAKE WILLIAMS	8.4
ROBINSON	10.0
TUTTLE	8.2
ARENA	5.8
WING	12.1
REGAN	5.1
STILL	6.9
WILTON	

284

Rule S-225

DAKOTA DIVISION

13th Subdivn  
BRANCH LINE

STATIONS  
Office Calls

Rule 6(A) Signs	Station Numbers	Line Segment	Mile Post Location	Distance From Casselton
JTY	00698		0.0	0.0
	56206		5.7	6.2
	56212		12.3	12.7
	56219		18.6	19.0
	56232		32.2	32.7
	56241		40.7	41.2
	56247		47.3	47.8
	56252		52.5	53.0
T	56260		60.3	60.7

CT CASSELTON	6.2
MYRA	6.5
EMBDEN	6.3
ALICE	13.7
NOME	8.5
KATHRYN	6.6
HASTINGS	5.2
LITCHVILLE	7.7
MARION	

278

BN Radio Channel No. 1 in service on these Subdivisions.

DAKOTA DIVISION

16th Subdivn BRANCH LINE						
Rule 6(A) Signs	Station Numbers	Line Segment	Mile Post Location	Distance From Oakes		
<b>STATIONS</b>						
<b>Office Calls</b>						
JRTY	56969	<b>283</b>	14.8	0.0	KS <b>OAKES</b> 7.6	
	56982		7.7	7.6		<b>GLOVER</b> 7.8
JRTY	56683		0.0	15.4		
		<b>276</b>	81.7			
<b>BETWEEN INDEPENDENCE AND LAMOURE DAKOTA DIVISION TWELFTH SUBDIVISION TIMETABLE, AND SPECIAL INSTRUCTIONS GOVERN.</b>						
JRY	56688	<b>276</b>	87.0		5.2 <b>LAMOURE</b> 7.7	
			48.5	20.6		<b>GRAND RAPIDS</b> 8.5
	56941	<b>282</b>	41.2	28.3	<b>DICKEY</b> 6.3 <b>ADRIAN</b> 7.4 <b>MONTPELIER</b> 6.1 <b>YPSILANTI</b> 12.7	
	56933		32.6	36.8		
	56926		26.4	43.1		
	56919		19.0	50.5		
	56913		13.0	56.6		
		<b>280</b>	0.6		JY <b>JAMESTOWN</b> 6.5	
BJK RTXY	03336		0.0	69.3		<b>PARK HURST</b> 7.0 <b>BUCHANAN</b> 7.9 <b>PINGREE</b> 6.5 <b>EDMUNDS</b> 6.8 <b>MELVILLE</b> 9.1 <b>CARRINGTON</b> 4.6 <b>GUPTILL</b> 3.7 <b>BARLOW</b>
	57507	5.2	75.8			
	57513	12.2	82.8			
JRTY	57521	20.1	90.7			
	57528	26.6	97.2			
	57535	33.4	104.0			
JRTUY	57544	42.5	113.1			
	57548	47.1	117.7			
	57522	50.8	121.4			
JT	00808	58.5	129.1			
	57811	69.6	140.2			
JT	57820	78.3	148.9			
	57831	89.6	159.7			
				KO <b>NEW ROCKFORD</b> 11.1 <b>SHEYENNE</b> 8.7 <b>OBERON</b> 10.8 <b>MINNEWAUKAN</b>		

DAKOTA DIVISION

17th Subdivn BRANCH LINE					
Rule 6(A) Signs	Length of Siding in Feet	Station Numbers	Line Segment	Mile Post Location	Distance From McKenzie
<b>STATIONS</b>					
<b>Office Calls</b>					
JT		03419	<b>290</b>	0.0	0.00
U		57212		11.6	11.7
		57219		19.7	19.8
	2133	57228		27.7	27.7
	1983	57237		36.7	36.7
			<b>292</b>	45.3	
TY		57245		75.0	44.6
	2042	57255		65.1	54.5
	1450	57267		53.9	65.7
	2087	57270		44.8	74.8
		57284		36.9	81.2
Y		57294		26.0	93.6
					<b>McKENZIE</b> 11.7 <b>MOFFITT</b> 8.1 <b>DANA</b> 7.9 <b>HAZELTON</b> 9.0 <b>TEMIK</b> 7.9  <b>LINTON</b> 9.9 <b>STRASBURG</b> 11.2 <b>HAGUE</b> 9.1 <b>ZEELAND</b> 7.9 <b>GREENWAY</b> 10.9 <b>EUREKA</b>

BN Radio Channel No. 1 in service on these Subdivisions.

DAKOTA DIVISION

18th Subdivn BRANCH LINE					
Rule 6(A) Signs	Station Numbers	Line Segment	Mile Post Location	Distance From Carrington	
<b>STATIONS</b>					
<b>Office Calls</b>					
JRTY	57544	<b>285</b>	0.0	0.0	Rule S-225 <b>CARRINGTON</b> 7.1 <b>DOVER</b> 5.9 <b>SYKESTON</b> 7.0 <b>HEATON</b> 7.7 <b>BOWDON</b> 5.4 <b>CHASELEY</b> 5.2 <b>HURDSFIELD</b> 9.4 <b>GOODRICH</b> 6.6 <b>DENHOFF</b> 9.0 <b>McCLUSKY</b> 13.0 <b>MERCER</b> 8.6 <b>TURTLE LAKE</b>
	57707		6.7	7.1	
	57713		12.6	13.0	
	57719		19.6	20.0	
	57727		27.3	27.7	
	57732		32.7	33.1	
	57738		37.9	38.3	
	57747		47.3	47.7	
	57754		53.9	54.3	
	57763		62.9	63.3	
	57776		75.8	76.3	
T	57784		85.0	84.9	

DAKOTA DIVISION

19th Subdivn BRANCH LINE					
Rule 6(A) Signs	Station Numbers	Line Segment	Mile Post Location	Distance From Oberon	
<b>STATIONS</b>					
<b>Office Calls</b>					
JT	57820	<b>286</b>	0.0	0.0	Rule S-225 <b>OBERON</b> 5.3 <b>JOSEPHINE</b> 5.0 <b>FLORA</b> 5.2 <b>MADDOCK</b> 12.2 <b>ESMOND</b>
	57905		5.3	5.3	
	57910		10.2	10.3	
	57915		15.4	15.5	
	57928		28.1	27.5	

DAKOTA DIVISION

20th Subdivn  
BRANCH LINE

STATIONS  
Office Calls

CHURCHS FERRY	15.4
CANDO	12.5
BISBEE	7.5
PERTH	12.2
ROLLA	7.5
ST. JOHN	

267

Rule S-225

DAKOTA DIVISION

23rd Subdivn  
BRANCH LINE

STATIONS  
Office Calls

TOWNER	22.1
UPHAM	12.7
NEWBURG	

270

Rule S-225

DAKOTA DIVISION

21st Subdivn  
BRANCH LINE

STATIONS  
Office Calls

YORK	14.3
WOLFORD	13.0
ROLETTE	14.8
DUNSEITH	

268

Rule S-225

DAKOTA DIVISION

24th Subdivn  
BRANCH LINE

STATIONS  
Office Calls

GRANVILLE	13.0
DEERING	11.5
GLENBURN	10.8
LANSFORD	11.1
MOHALL	15.3
SHERWOOD	

271

Rule S-225

DAKOTA DIVISION

22nd Subdivn  
BRANCH LINE

STATIONS  
Office Calls

RUGBY	12.8
BARTON	8.4
WILLOW CITY	7.4
OMEMEE	9.5
BOTTINEAU	6.7
CARBURY	6.3
SOURIS	5.5
ROTH	5.1
LANDA	5.5
WESTHOPE	13.0
ANTLER	

269

Rule S-225

DAKOTA DIVISION

25th Subdivn  
BRANCH LINE

STATIONS  
Office Calls

BERTHOLD	20.5
COULEE	7.0
KENASTON	6.7
NIobe	6.7
COTEAU	14.2
LIGNITE	2.1
LIGNITE JCT.	8.0
KINCAID	3.4
LARSON	6.9
NOONAN	13.2
CROSBY	

263

BN Radio Channel No. 1 in service on these Subdivisions.

## DAKOTA DIVISION

WESTWARD		26th Subdivn BRANCH LINE					EASTWARD	
Rule 6(A) Signs	Station Numbers	Line Segment	Mile Post Location	Distance From Niobe	STATIONS			
					Office Calls			
JRTY	58634	264	0.0	0.0	NIOBE 8.3			
A	58708		8.0	8.3	BOWBELLS 12.8			
Y	58721		20.8	21.1	NORTHGATE 0.6			
J	58723		21.5	21.7	BOUNDARY LINE			

## DAKOTA DIVISION

WESTWARD		27th Subdivn BRANCH LINE					EASTWARD	
Rule 6(A) Signs	Station Numbers	Line Segment	Mile Post Location	Distance From Stanley	STATIONS			
					Office Calls			
JT	00970	265	0.0	0.0	STANLEY 10.2			
	58812		11.7	13.2	LOSTWOOD 12.8			
	58825		24.6	26.0	POWER'S LAKE 7.1			
	58832		31.7	33.1	BATTLEVIEW 6.4			
	58838		38.0	39.5	MCGREGOR 12.3			
	58850		50.4	51.8	WILDROSE 13.9			
	58864		64.3	65.7	ALAMO 5.5			
	58870		69.8	71.2	APPAM 4.8			
	58875		74.6	76.0	ZAHL 12.0			
RT	58887		87.1	88.0	GRENORA			
					Rule S-225			

## DAKOTA DIVISION

WESTWARD		28th Subdivn BRANCH LINE					EASTWARD	
Rule 6(A) Signs	Station Numbers	Line Segment	Mile Post Location	Distance From Nolan	STATIONS			
					Office Calls			
J	00724	24	24.3	0.0	NOLAN 1.6			
	57002		25.7	1.6	PAGE 7.1			
	57009		32.8	8.7	COLGATE 6.3			
	57015		39.2	15.0	HOPE 9.3			
	57024		48.4	24.3	PICKERT 5.0			
	57029		53.3	29.3	FINLEY 6.5			
	57036		59.8	35.8	SHARON 7.1			
	57043		66.9	42.9	ANETA 4.9			
	57048		71.9	47.8	KLOTEN 6.0			
	57054		77.8	53.8	MCVILLE 7.3			
	57061		85.1	61.1	PEKIN 5.8			
	57067		90.9	66.9	TOLNA 12.7			
	57080		103.7	79.6	WARWICK			
					Rule S-225			

## DAKOTA DIVISION

WESTWARD		29th Subdivn BRANCH LINE					EASTWARD	
Rule 6(A) Signs	Station Numbers	Line Segment	Mile Post Location	Distance From Lakota	STATIONS			
					Office Calls			
JTY	05359	279	0.0	0.0	LAKOTA 12.4			
	55812		12.0	12.4	BROCKET 6.3			
	55818		17.3	18.7	LAWTON 8.5			
	55827		27.0	27.2	EDMORE 12.9			
	55840		39.7	40.1	HAMPDEN 12.3			
	55852		52.1	52.4	MUNICH 7.5			
	55860		59.5	59.9	CLYDE 5.9			
	55866		65.5	65.8	CALVIN 7.4			
T	55872		73.0	73.2	SARLES			
					Rule S-225			

## DAKOTA DIVISION

WESTWARD		30th Subdivn BRANCH LINE					EASTWARD	
Rule 6(A) Signs	Station Numbers	Line Segment	Mile Post Location	Distance From Devils Lake	STATIONS			
					Office Calls			
BJKR TUY	05383	275	0.0	0.0	WS DEVILS LAKE 12.1			
	55912		11.8	12.1	WEBSTER 11.9			
	55924		23.4	24.0	STARKWEATHER 15.7			
U	55939		39.4	39.7	OLMSTEAD 13.5			
	55953		53.0	53.2	ROCK LAKE 12.8			
T	55966		66.6	66.0	HANSBORO			
					Rule S-225			

## DAKOTA DIVISION

EASTWARD		31st Subdivn BRANCH LINE					WESTWARD	
Rule 6(A) Signs	Station Numbers	Line Segment	Mile Post Location	Distance From Larimore	STATIONS			
					Office Calls			
JKRTY	05323	23	129.6	0.0	LARIMORE 12.6			
	56353		117.4	12.6	NORTHWOOD 8.5			
	56345		109.0	21.1	HATTON 6.5			
JT	56338		102.4	27.6	PORTLAND JCT. 4.9			
Y	56333		96.0	32.5	MAYVILLE			
					Rule S-225			

BN Radio Channel No. 1 in service on these Subdivisions.



## FREIGHT TRAIN SCHEDULES

(For Information Only)

### DAKOTA DIVISION

WESTWARD							
Train No.	DIL-WORTH	FARGO		CASSEL-TON	MINOT		WILLIS-TON
	Leave	Arrive	Leave	Leave	Arrive	Leave	Arrive
BPX	12:55AM	1:15AM	1:45AM		6:30AM	7:15AM	10:30AM
3	6:35AM				11:05AM	11:45AM	2:05PM
23	3:50PM				8:20PM	9:00PM	11:20PM
57	8:40PM	9:10PM	9:40PM		4:00AM	4:30PM	8:30PM
81				9:00PM	3:00AM		
83	6:40AM	7:00AM	8:30AM		3:00PM	11:30PM	3:30AM
97	4:25AM	4:45AM	5:45AM	6:10AM	10:45AM	12:15PM	3:30PM
73						10:00PM	1:15AM
Train No.	DILWORTH	JAMESTOWN		MANDAN			
	Leave	Arrive	Leave	Arrive			
85	9:40PM	12:05AM	12:20AM	2:50AM			
CHB	8:55PM	11:05PM	11:20PM	1:50AM			
Train No.	BRECKEN-RIDGE	CASSEL-TON	FARGO		GRAND FORKS	MINOT	
	Leave	Arrive	Leave	Arrive	Leave	Arrive	
81	7:00PM	9:00PM				3:00AM	
131	7:30AM		9:00AM	10:00AM	1:30PM		
EASTWARD							
Train No.	WILLIS-TON	MINOT		FARGO	DIL-WORTH	BRECKENRIDGE	
	Leave	Arrive	Leave	Arrive	Arrive	Arrive	Leave
PBF	3:05PM	6:30PM	7:45PM		1:15AM		
4	2:55PM	6:20PM	7:20PM		12:55AM		
80	4:30PM	8:30PM	10:15PM		4:45AM		
82	12:15PM	3:35PM	4:55PM		10:35PM		
84	7:00AM	10:45AM	12:45PM		6:45PM		
88	5:15AM	9:00AM	11:00AM		5:00PM		
172	2:15PM	6:00PM	4:15AM			2:15PM	3:15PM
182	1:10PM	4:40PM	6:00PM		11:30PM		
Train No.	MANDAN	JAMESTOWN		DILWORTH			
	Leave	Arrive	Leave	Arrive			
86	7:40AM	10:25AM	10:35AM	2:00PM			
Train No.	GRAND FORKS	FARGO		BRECKEN-RIDGE			
	Leave	Arrive	Leave	Arrive			
132	1:30PM	4:00PM	5:30PM	7:00PM			

## DAKOTA DIVISION

## INDUSTRIAL TRACKS AND OTHER TRACKS NOT SHOWN AS STATIONS IN TIME TABLE

Name	Location	Capacity Cars	Switch Opens	Name	Location	Capacity Cars	Switch Opens
<b>First Subdivision</b>				<b>Eighteenth Subdivision</b>			
00692 Norpak	2.4 miles west of Mapleton	20	East	57769 Picardville	6.1 miles west of McClusky	12	East
00695 Dalrymple	5.3 miles west of Mapleton	37	West	<b>Twentieth Subdivision</b>			
03270 Wheatland	6.5 miles west of Casselton	23	East	58007 Maza	7.4 miles west of Churchs Ferry	25	Both
03301 Valley City Freight	5.1 miles east of Berea	Yard	Both	58022 Considine	6.2 miles west of Cando	35	Both
03321 Urbana	3.9 miles west of Eckelson	55	East	58046 Wayne IMP Spur	11.9 miles west of Perth	8	West
03326 Ladish Spur	0.2 miles west of Spiritwood	Yard	East	<b>Twenty-First Subdivision</b>			
03339 Klose Elevator	1.7 miles west of Jamestown	65	Both	58134 Thorne	6.8 miles west of Rolette	36	Both
03345 Standard Spur	2.2 miles west of Eldridge	23	East	<b>Twenty-Second Subdivision</b>			
<b>Second Subdivision</b>				58206 Leverich	6.3 miles west of Rugby	10	Both
Mindak Coop Beet Spur	4.0 miles west of Wahpeton	142	East	58273 Kuroki	6.2 miles west of Westhope	20	Both
Froedtert Malting	4.9 miles west of Wahpeton	160	West	<b>Twenty-Third Subdivision</b>			
10007 Brushvale	7.4 miles west of Wahpeton	22	Both	58314 Bantry	14.0 miles west of Towner	28	Both
10033 Rustad	5.1 miles west of Comstock	35	Both	<b>Twenty-Fourth Subdivision</b>			
<b>Third Subdivision</b>				58418 Wolseth	4.9 miles west of Deering	14	Both
03250 Addison	3.8 miles west of Davenport	33	Both	58430 Forfar	5.2 miles west of Glenburn	13	East
56507 Lynchburg	7.2 miles west of Chaffee Line Jct.	26	Both	58454 Lorain	7.2 miles east of Sherwood	14	Both
56512 Chaffee	11.6 miles west of Chaffee Line Jct.	10	Both	<b>Twenty-Fifth Subdivision</b>			
<b>Fourth Subdivision</b>				58607 Hartland	13.5 miles east of Coulee	21	Both
00750 Karnak	6.3 miles west of Luverne	40	East	58654 TXL Track	1.0 mile east of Lignite	33	Both
00815 Munster	6.8 miles west of New Rockford	30	East	58663 Stampede	2.1 miles east of Kincaid	34	Both
00839 Wellsburg	6.1 miles west of Heimdahl	46	East	<b>Twenty-Seventh Subdivision</b>			
00886 Falsen Pit	2.8 miles west of Karlsruhe	122	East	58818 Lunds Valley	6.3 miles west of Lostwood	24	Both
00902 Genoa	6.4 miles west of Simcoe	38	East	58844 Hamlet	5.9 miles east of Wildrose	25	Both
<b>Fifth Subdivision</b>				<b>Twenty-Eighth Subdivision</b>			
NSP Co. Spur	1.9 miles west of Jy Jct.	1	East	57073 Hamar	6.3 miles west of Tolna	31	Both
<b>Seventh Subdivision</b>				<b>Thirtieth Subdivision</b>			
00934 Lonetree	4.1 miles west of Des Laes	38	Both	55917 Garske	5.2 miles west of Webster	21	Both
<b>Eighth Subdivision</b>				55929 St. Joe	4.8 miles west of Starkweather	14	Both
10078 Kelso	6.1 miles west of Grandin	32	Both	55946 Crocus	6.6 miles west of Olmstead	27	Both
10086 Redco Spur	1.75 miles west of Hillsboro	81	West	<b>Thirty-First Subdivision</b>			
10088 Taft	3.7 miles west of Hillsboro	26	East	56360 Kempton	6.3 miles east of Larimore	43	Both
10104 Tri-Dees Potato Whse.	0.8 mile west of Reynolds	8	East	56343 Hunter Commodity Spur	0.8 miles east of Hatton	8	East
10115 Merrifield	4.9 miles west of Thompson	39	Both	56344 Olaf Bye & Sons Spur	0.7 mile east of Hatton	10	East
10118 Flaata	2.9 miles west of Merrifield	13	Both	56428 Portland	4.5 miles east of Portland Jct.	65	Both
10120 Prairie Sub Station	1.0 mile west of Flaata	10	East	56332 Occidental Agri. Chemicals Spur	1.0 mile east of Mayville	9	West
<b>Ninth Subdivision</b>				56331 Mayville Pelleting Co. Spur	1.1 miles east of Mayville	6	East
05353 Mapes	4.7 miles west of Michigan	43	Both	Gormley Bean Co.	1.2 miles east of Mayville	13	East
05378 Keith	5.6 miles west of Crary	21	Both	<b>Twelfth Subdivision</b>			
00912 Swenson	2.4 miles west of Surrey	139	East	56657 Lisbon Pit	1.0 mile west of Lisbon	42	East
58515 Tatman	15.8 miles west of J. D. Switch	182	East	56710 Edgeley	1.6 miles west of Edgeley Jct.	40	Both
<b>Sixteenth Subdivision</b>				<b>Sixteenth Subdivision</b>			
57812 Sheyenne Pit	1.0 mile west of Sheyenne	91	East	<b>Seventeenth Subdivision</b>			
<b>Seventeenth Subdivision</b>				57217 Suetz Spur	2.9 miles east of Dana	5	East

**DAKOTA DIVISION  
LINE SEGMENT NUMBERS**

**YARD SEGMENT NUMBERS**

Line Segment	Yard	Mileposts
287	Jamestown—State Hospital	40.2 to 38.3
468	Gavin Yard	
560	Dilworth	
561	Fargo	
562	Fargo WFE	
563	Fargo (EX-Milw)	
564	Breckenridge	
565	Minot Yard	
566	Jamestown	
567	Linton (EX-Milw)	
568	Edgeley (EX-Milw)	
569	Wahpeton (EX-Milw)	

**BALLAST PITS**

Line Segment	Ballast Pit
582	Falsen
583	Lisbon
584	Minot
585	Sheyenne

**OTHER ROAD LINE SEGMENTS**

Line Segment	Limits	Mileposts
266	Valley City Low Line	64.4 to 70.6
272	Tatman Spur	0.0 to 16.7
274	Portland—Portland Jct.	27.6 to 32.5
277	Edgeley Jct.—Edgeley	0.0 to 1.6
289	Addison—Chaffee	0.0 to 12.0
291	Fargo—Dakota Jct.	4.2 to 5.6

**CHIEF MEDICAL OFFICERS**

Dr. Abbott Skinner, Chief Medical Officer ..... St. Paul, MN  
 Dr. Thomas V. Mears, Associate Chief Medical Officer ..... St. Paul, MN

**OPHTHALMOLOGISTS**

(Eye Doctors)

Duluth, Mn. .... Dr. John E. Power, Jr.	Minot, N.D. .... Dr. Burton G. Olson	Sioux City, Iowa ..... Dr. James E. Reeder
Grand Forks, N.D. .... Dr. L. J. Prochaska	St. Paul, Mn. .... Dr. L. G. Edwards	Sioux Falls, S.D. .... Dr. E. A. Pasek
Minneapolis, Mn. .... Dr. Richard C. Horns	St. Paul, Mn. .... Dr. M. W. Lufkin	Superior, Wis. .... Dr. Roger T. Thompson
Minneapolis, Mn. .... Dr. Brooks J. Poley	St. Paul, Mn. .... Dr. Donald C. Sterner	Willmar, Mn. .... Dr. Stanley S. Chunn
Minneapolis, Mn. .... Dr. Malcolm A. McCannel		

**MEDICAL EXAMINERS AND LOCAL SURGEONS**

Dr. A. C. Vogele	Aberdeen	Dr. Richard F. Hirt	Minneapolis
Dr. Douglas E. Perkins	Alexandria	Dr. Robert D. Hart	Minneapolis
Dr. L. C. Lundsten	Bemidji	Dr. H. Horecki	Minneapolis
Dr. Roger J. Bauer	Benson	Dr. Carl O. Rice	Minneapolis
Dr. R. P. Griffin	Benson	Dr. T. A. Langager	Minot
Dr. R. J. Dunnigan	Bismarck	Dr. R. L. Odegard	Minot
Dr. R. L. Jennings	Bismarck	Dr. Michael Haley	Mitchell, S.D.
Dr. John H. Aga	Brainerd	Dr. John A. Gjevve	Moorhead
Dr. William J. Knipp	Brainerd	Dr. R. A. Rossberg	Morris
Dr. C. W. Jacobson	Breckenridge	Dr. Jack Guy	New London
Dr. G. E. Larson	Cambridge	Dr. Robert H. Delano	Northwood
Dr. Mark H. Brakke	Coon Rapids	Dr. T. J. Bloedel	Osseo
Dr. R. N. de Niord	Crookston	Dr. Henry A. Korda	Pelican Rapids
Dr. D. E. Stewart	Crookston	Dr. J. L. Delmore, Jr.	Roseau
Dr. R. O. Sather	Crookston	Dr. W. R. Fox	Rugby
Dr. John K. Wood	Crookston	Dr. Everett J. Schmitz	St. Cloud
Dr. C. O. McPhail	Crosby	Dr. Vernon E. Neils	St. Cloud
Dr. Joseph C. Houts	Dassel	Dr. D. M. Van Nostrand	St. Cloud
Dr. J. B. Rutledge	Detroit Lakes	Dr. R. M. Ahrens	St. Paul
Dr. M. E. Odland	Detroit Lakes	Dr. Robert S. Flom	St. Paul
Dr. J. F. Knapp	Detroit Lakes	Dr. Darrel E. Westover	St. Paul
Dr. E. S. Lorentzen	Detroit Lakes	Dr. J. W. LaFave	St. Paul
Dr. R. Donald McBane	Devils Lake	Dr. Felix Gudio	St. Paul
Dr. G. W. Toomey	Devils Lake	Dr. J. E. Brown	St. Paul
Dr. N. E. Tosseland	Duluth	Dr. Charles W. Hauser	St. Paul
Dr. Roy R. Juntunen	Duluth	Dr. Richard J. Webber	St. Paul
Dr. Henry Norum	Fargo	Dr. John C. Grant	Sauk Centre
Dr. Eusebio R. Mendoza	Fargo	Dr. Julian F. DuBois, Jr.	Sauk Centre
Dr. C. M. Hunter	Fargo	Dr. A. L. McGilvra	Sioux Center
Dr. D. C. Kana	Fargo	Dr. H. E. Rudersdorf	Sioux City
Dr. James T. Talbot	Fargo	Dr. John W. Donahoe	Sioux Falls
Dr. George A. Sather	Fosston	Dr. R. J. Lelwica	Staples
Dr. M. W. Scheflo	Grafton	Dr. W. I. Mennis	Staples
Dr. W. P. Teevens	Grafton	Dr. H. V. Pearson	Stillwater
Dr. Walter C. Dailey	Grand Forks	Dr. Wm. D. Berg	Superior, WI
Dr. William T. Powers	Grand Forks	Dr. Enzo Krahl	Superior
Dr. Daniel W. Goodwin	Grand Forks	Dr. E. G. Stack	Superior
Dr. John B. Evensta	Grand Rapids	Dr. Neil A. MacDonald	Valley City
Dr. Carl L. Lundell	Granite Falls	Dr. Charles J. Mock	Virginia
Dr. Charles W. Decker	Hibbing	Dr. Kenneth A. Muckala	Wadena
Dr. John J. Muller	Hibbing	Dr. Paul J. Beithon	Wahpeton
Dr. Robert W. McLean	Hillsboro	Dr. G. Robert Bartron	Watertown
Dr. Kenneth H. Peterson	Hutchinson	Dr. J. E. Adducci	Williston
Dr. F. H. Walter	International Falls	Dr. Robert C. Koch	Williston
Dr. Edwin O. Hieb	Jamestown	Dr. Edward J. Hagan	Williston
Dr. R. S. Woodward	Jamestown	Dr. Lloyd C. Gilman	Willmar
Dr. N. J. Kaluzniak	Langdon	Dr. Michael T. Anderson	Willmar
Dr. C. O. Haugen	Larimore	Dr. Charles M. Burns	Winnipeg
Dr. Daniel R. Beckman	Marshall	Dr. George A. Waugh	Winnipeg
Dr. Phillip C. Hendenstrom	Marshall		
Dr. Clarence S. Martin	Medina		
Dr. Paul J. Keith	Milaca		
Dr. Azam Ansari	Minneapolis		
Dr. D. R. Blowers	Minneapolis		

**Milwaukee Corridor - Physical Applications**

Milbank Clinic - Dr. E.A. Johnson ..... Milbank, S.D.  
 Mobridge Clinic - Dr. L.M. Linde ..... Mobridge, S.D.  
 United Clinics - Dr. Gerald T. Sailer ..... Hettinger, S.D.

Other Physicians in the above offices are authorized to perform Examinations

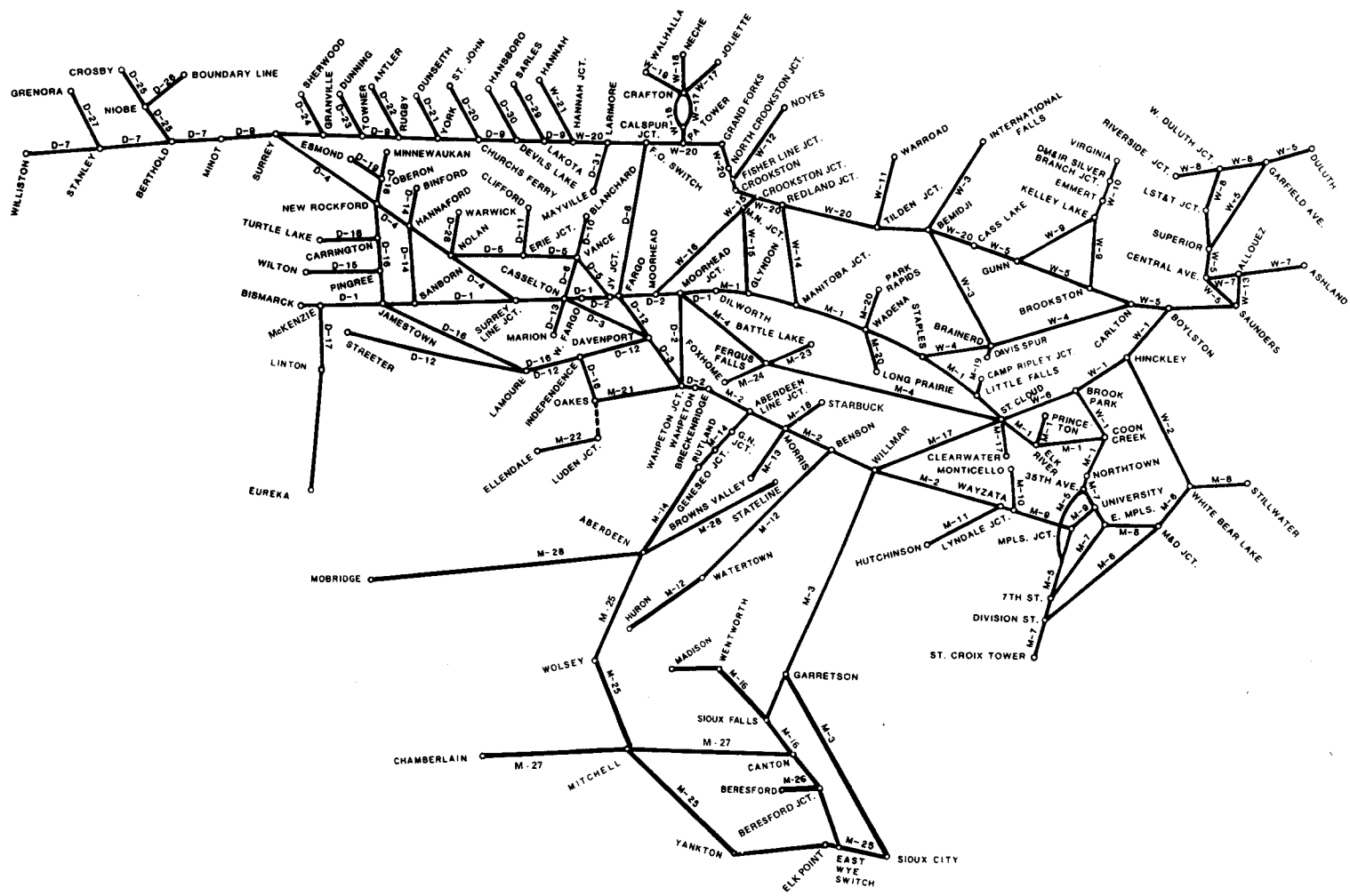

TWIN CITIES REGION

LEGEND:  
 DAKOTA DIVISION SUBDIVISION ----- D-1  
 MINNESOTA DIVISION SUBDIVISION ----- M-1  
 WISCONSIN DIVISION SUBDIVISION ----- W-1

FOR INFORMATION PURPOSES ONLY

# CAR CHART

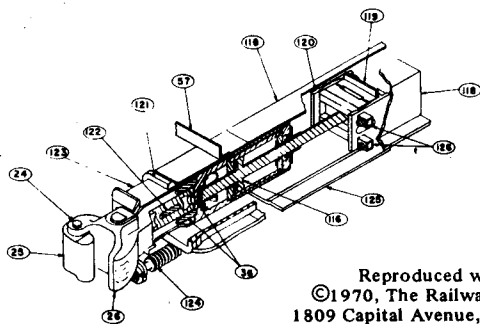
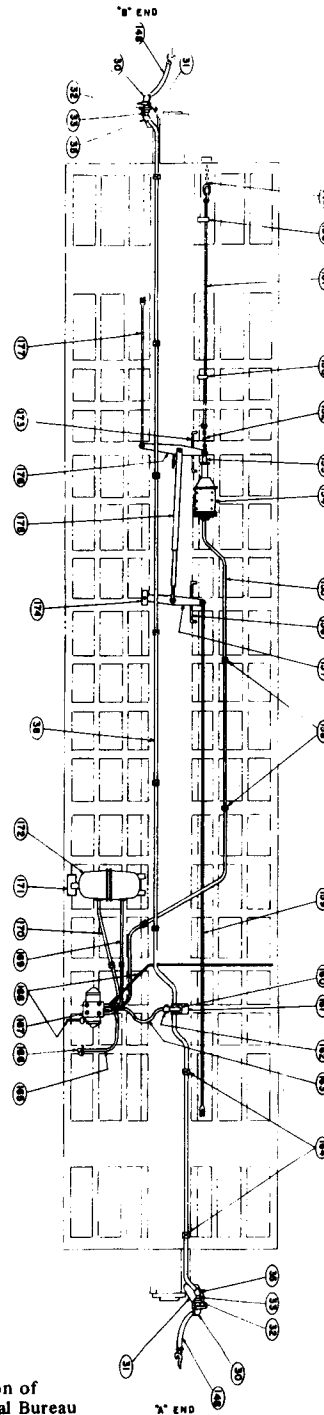
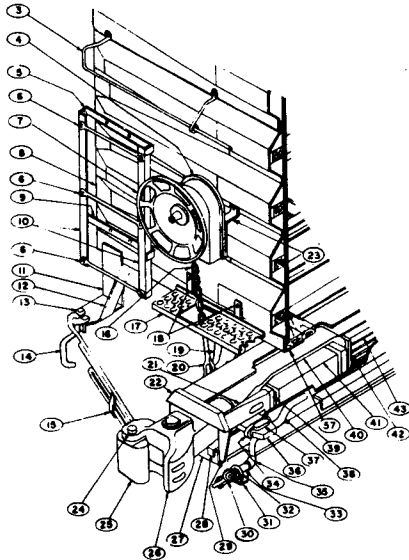
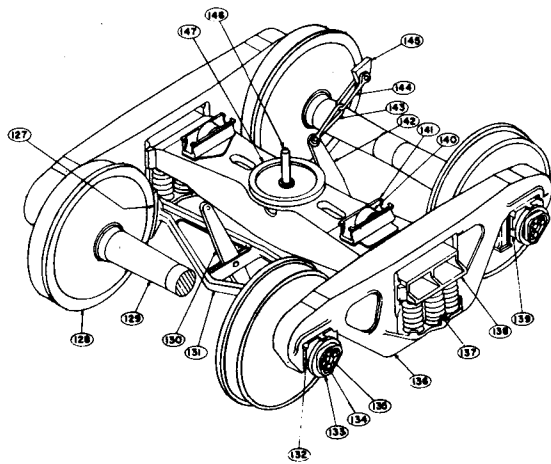

END-OF-CAR  
CUSHIONING

Reproduced with permission of  
©1970, The Railway Educational Bureau  
1809 Capital Avenue, Omaha, Nebraska 68102  
Simmons-Boardman Publishing Corporation

3. Horizontal end handhold
4. Hand brake housing
5. End ladder support—top
6. End ladder tread
7. Hand brake wheel
8. Steel end—bottom
9. End ladder support—bottom
11. Uncoupling lever bracket
12. Uncoupling lever bracket support
13. Uncoupling lever support
14. Telescoping uncoupling rod
15. Uncoupling lever guide
16. Hand brake chain
17. End platform (combined crossover and brake step)
18. End platform support
19. Bell crank
20. Vertical hand brake rod
21. Front draft gear stop
22. Striker
23. Hand brake housing support
24. Coupler knuckle pin
25. Coupler knuckle
26. Type E coupler head
27. Coupler carrier
28. Coupler wear plate
29. Striker flange
30. Angle cock
31. Angle cock support
32. Angle cock "U" bolt
33. Nipple
34. Draft key washer
35. 45° elbow
36. Draft key
37. Draft key retainer
38. Brake pipe, 1/4" (Train line)
39. Follower block
40. Coupler yoke
41. Draft gear
42. Rear draft gear stop
43. Rear draft gear stop reinforcement
116. Hydraulic piston
118. Center sill
119. Back stop plate
120. Rear lug casting
121. Striker casting
122. Coupler key
123. Cushioning unit
124. Restoring mechanism
125. Inspection plate
126. Rear cross key
127. Brake shoe
128. Wheel
129. Axle
130. Truck live lever
131. Brake beam
132. Roller bearing adapter
133. Roller bearing end cap
134. End cap retaining bolt
135. End cap locking plate
136. Truck side frame
137. Truck spring
138. Truck bolster
139. Roller bearing assembly
140. Truck side bearing roller
141. Truck side bearing housing
142. Truck dead lever
143. Clevis at dead lever
144. Clevis at dead lever fulcrum
145. Dead lever anchor—underframe mounted
146. Center pin
147. Truck center plate cast integral with truck bolster
148. Air hose
149. Hand brake chain at bell crank
150. Hand brake rod guide
151. Hand brake rod
152. Hand brake chain at cylinder
153. Cylinder push rod
154. Air brake cylinder
155. Cylinder pipe, 3/4"
156. Floating lever guide
157. Floating lever
158. Pipe clamp, 3/4"
159. Top rod, "A" end
160. Branch pipe tee
161. Branch pipe tee support
162. Combined dirt collector and cut-out cock
163. Connection hose
164. Pipe clamp, 1/2"
165. Retainer pipe
166. Retainer valve
167. ABD control valve
168. Release rod
169. Auxiliary reservoir pipe, 3/4"
170. Emergency reservoir pipe, 3/4"
171. Reservoir support
172. Combined auxiliary and emergency reservoir
173. Cylinder lever guide
174. Brake lever fulcrum
175. Brake slack adjuster
176. Cylinder lever
177. Top rod, "B" end

## POSITION IN FREIGHT TRAIN OF PLACARDED CARS

PLACARD APPLIED ON CAR		EXPLOSIVES - A	POISON GAS	LOADED PLACARDED TANK CARS (EXCEPT POISON GAS OR COMBUSTIBLE)	EMPTY PLACARDED TANK CARS (EXCEPT POISON GAS)	RADIOACTIVE	COMBUSTIBLE	ALL OTHER PLACARDED CARS
<b>RESTRICTIONS</b>								
MUST NOT BE NEARER THAN THE SIXTH CAR FROM ENGINE OR CABOOSE. HOWEVER WHEN LENGTH OF TRAIN WILL NOT PERMIT CAR TO BE SO PLACED IT MUST BE PLACED NEAR MIDDLE OF TRAIN.		X	X	X				
<b>PLACARDED CAR MUST NOT BE PLACED NEXT TO</b>	ENGINE	X	X	X	X	X		
	OCCUPIED CABOOSE	X <sup>①</sup>	X <sup>①</sup>	X	X	X		
	LOADED FLAT CARS <sup>①</sup>	X	X	X <sup>②</sup>				
	OPEN TOP CARS <sup>③</sup>	X	X	X				
	CARS WITH ANY OF THE FOLLOWING OPERATING: AN ENGINE LIGHTED HEATERS STOVES OR LAMPS AUTOMATIC REFRIG- ERATION UNITS	X	X	X				
	OCCUPIED CAR	X <sup>①</sup>	X <sup>①</sup>	X				
	EXPLOSIVES - A		X	X		X	X	
	POISON GAS	X		X		X	X	
	RADIOACTIVE	X	X	X				X
	UNDEVELOPED FILM					X		
EMPTY PLACARDED TANK CARS								
ANY LOADED PLACARDED CAR (EXCEPT COMBUSTIBLE)	X	X			X			

**HOW TO USE THIS CHART**

To determine the type of placard applied to car — follow vertical line down and note which lines apply by "X" shown in box

**... NOTE ...**

*Cars with same placards may be placed next to each other.*

**Footnotes:** ① A flatcar equipped with permanently attached ends of rigid construction is considered to be an open-top car.

② A loaded flatcar, other than a specially equipped car in trailer-on-flat-car or container-on-flatcar service or a flatcar loaded with vehicles secured by means of a device designed for that purpose and permanently installed on the flatcar, and of a type generally accepted for

handling in interchange between railroads. This exception for cars in trailer-on-flatcar service does not apply to loaded flatbed trucks, loaded flatbed trailers, loaded open-top trailers, or loaded trucks or trailers without securely closed doors.

③ An open-top car when any of the lading protrudes beyond the car ends or when any of the lading extending above the car ends is liable to

shift so as to protrude beyond the car ends.

④ A rail car placarded "EXPLOSIVES A" or "POISON GAS" in a moving or standing train must be next to and ahead of any car occupied by the guards or technical escorts accompanying this car. However, if a car occupied by guards or technical escorts is equipped with a lighted heater or stove, it must be the fourth car behind any car requiring "EXPLOSIVES A" placards.

PERFORM SWITCHING IN A MANNER WHICH WILL AVOID DAMAGE TO CONTENTS OF CARS AND EQUIPMENT

Safe Coupling Speed (MPH)	Impact Force
1	1
2	4
3	9
4	16
Damaging Coupling Speed (MPH)	Damaging Force
5	25
6	36
7	49
8	64
9	81
10	100

**SPEED TABLE**

Time Per Mile		Miles Per Hour	Time Per Mile		Miles Per Hour
Minutes	Seconds		Minutes	Seconds	
0	45	80.0	1	12	50.0
0	46	78.3	1	15	48.0
0	47	76.6	1	20	45.0
0	48	75.0	1	25	42.3
0	49	73.5	1	30	40.0
0	50	72.0	1	40	36.0
0	51	70.6	1	45	34.3
0	52	69.2	1	50	32.7
0	53	67.9	2	....	30.0
0	54	66.6	2	10	27.6
0	55	65.4	2	15	26.6
0	56	64.2	2	20	25.7
0	57	63.1	2	30	24.0
0	58	62.0	2	40	22.5
0	59	61.0	2	45	21.8
1	....	60.0	2	50	21.2
1	1	59.0	3	....	20.0
1	2	58.0	3	9	19.0
1	3	57.1	3	20	18.0
1	4	56.2	3	31	17.0
1	5	55.3	3	45	16.0
1	6	54.5	4	....	15.0
1	7	53.7	5	....	12.0
1	8	52.9	6	....	10.0
1	9	52.1	7	30	8.0
1	10	51.4	10	....	6.0

**MAINTENANCE OF WAY  
CONDITIONAL STOP**

(Form Y Train Order)

The following forms of oral authorization by the Foreman and acknowledgment of understanding by the engineer are to be used to permit trains to pass a red flag without stopping within the limits of a Form Y train order.

Foreman will state: "Burlington Northern Railway Foreman calling Extra 232 East about Order No. (Form Y Train Order No.)"

Engineer must respond, identifying his train as: "This is Burlington Northern engineer, Extra 232 East."

When engineer has answered as above, the foreman will state: "Extra 232 East may pass red signal at (M.P. Location and specify track involved) without stopping."

The foreman may also authorize a different speed from that shown in the Form Y train order by adding to his instructions: "Proceed at \_\_\_\_\_ MPH," or "Proceed at normal speed."

The engineer must repeat back to the foreman the instructions that are given him.